

Job Name:	Date:
System Reference:	



### SPECIFICATIONS:

Rated Capacity*		
Cooling	Btu/h	12,000
Heating at 47° F	Btu/h	13,500

\*Rating Conditions per AHRI Standard:  
 Cooling | Indoor: 80° F (27° C) DB / 67° F (19° C) WB  
 Cooling | Outdoor: 95° F (35° C) DB / 75° F (24° C) WB  
 Heating at 47°F | Indoor: 70° F (21° C) DB / 60° F (16° C) WB  
 Heating at 47°F | Outdoor: 47° F (8° C) DB / 43° F (6° C) WB

For data on specific indoor units (all ducted, all non-ducted, and both ducted and non-ducted) combinations, see the MXZ Technical and Service Manual

Electrical Power Requirements	208 / 230V, 1-Phase, 60 Hz	
-------------------------------	----------------------------	--

Minimum Circuit Ampacity (MCA)	A	1
--------------------------------	---	---

Voltage		
Indoor - Outdoor S1-S2	AC	208 / 230V
Indoor - Outdoor S2-S3		+/- 24VDC

External Static Pressure	In. WG	0.30 - 0.50 - 0.80
--------------------------	--------	--------------------

External Finish	High-gloss polyester powder coated	
-----------------	------------------------------------	--

External Dimensions (H x W x D)	In.(mm)	50-1/4 x 17 x 21-5/8 (1,275 x 432 x 548)
---------------------------------	---------	---

Net Weight	Lbs.(kg)	113 (51)
------------	----------	----------

Sound Pressure Level (Low-Mid-Hi)		
Cooling	dB(A)	27 - 31 - 35
Heating		27 - 31 - 35

Airflow Rate (Low-Mid-Hi)		
Cooling (Dry)	CFM	280 - 340 - 400
Heating		280 - 340 - 400

Refrigerant Piping		
Liquid (High Pressure)	In.(mm)	1/4 (6.35)
Gas (Low Pressure)		1/2 (12.70)

Refrigerant	R410A	
-------------	-------	--

Connection Method	Flared	
-------------------	--------	--

### GENERAL FEATURES:

- Multi-position air handling unit
- Multi-Position installation without any additional kits
- Quiet operation
- Selectable external static pressure settings with capabilities up to 0.80 In. W.G.
- Auto fan speed control: Low, Medium, High
- Indoor unit powered from outdoor unit using A-Control (Optional)
- Auto restart following a power outage
- Limited warranty: five years parts and seven years compressors

### ACCESSORIES:

- Mini-Condensation Pump (SI30-115/230)
- Maxi Blue Diamond Condensate Pump 230V (X87-721)

# DIMENSIONS: MVZ-A12AA4

Unit: inch

Model	A	B	C	D	E	F	G	H	J	① Gas pipe	② Liquid pipe
WZ-A12AA4	432	376	281	224	1275	680	823	735.5	380	①12.7 (1/2)	②6.35 (1/4)
WZ-A18AA4	(17)	(14-13/16)	(11-1/8)	(8-7/8)	(50-1/4)	(28-13/16)	(32-1/8)	(29)	(14-3/16)	①15.88 (5/8)	②4.952 (3/8)
WZ-A24AA4	534	477	382.6	266.5	1378	737	953.5	792	461	①15.88 (5/8)	②4.952 (3/8)
WZ-A30AA4	(21)	(18-13/16)	(15-1/8)	(10-1/2)	(54-1/4)	(29-1/8)	(37-9/16)	(31-3/8)	(18-3/16)	①15.88 (5/8)	②4.952 (3/8)

Unit:mm(In.)

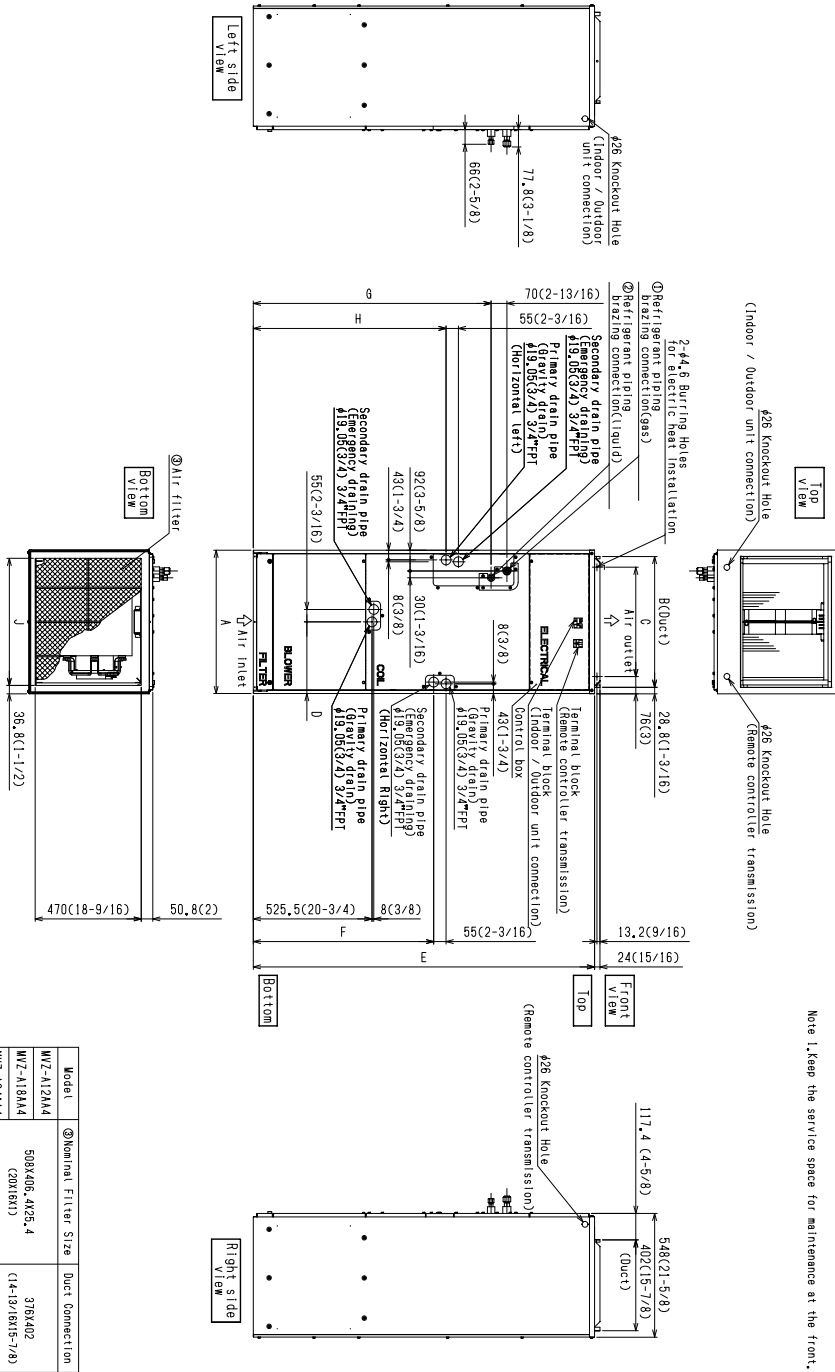

Note 1. Keep the service space for maintenance at the front.

Model	③ Nominal Filter Size	Duct Connection
WZ-A12AA4	509X406, 4X26, 4	376X402 (20X161)
WZ-A18AA4	509X406, 4X26, 4	(14-13/16)X(15-7/8)
WZ-A24AA4	509X406, 4X26, 4	477X402 (20X201)
WZ-A30AA4	509X406, 4X26, 4	(18-13/16)X(15-7/8)



**COOLING & HEATING**  
1340 Satellite Boulevard, Suwanee, GA 30024  
Toll Free: 800-433-4822 www.mehvac.com



Job Name:	Date:
System Reference:	



MVZ-A18AA4

### SPECIFICATIONS:

Rated Capacity*		
Cooling	Btu/h	18,000
Heating at 47° F	Btu/h	20,000

\*Rating Conditions per AHRI Standard:  
 Cooling | Indoor: 80° F (27° C) DB / 67° F (19° C) WB  
 Cooling | Outdoor: 95° F (35° C) DB / 75° F (24° C) WB  
 Heating at 47°F | Indoor: 70° F (21° C) DB / 60° F (16° C) WB  
 Heating at 47°F | Outdoor: 47° F (8° C) DB / 43° F (6° C) WB

For data on specific indoor units (all ducted, all non-ducted, and both ducted and non-ducted) combinations, see the MXZ Technical and Service Manual

Electrical Power Requirements	208 / 230V, 1-Phase, 60 Hz	
-------------------------------	----------------------------	--

Minimum Circuit Ampacity (MCA)	A	1
--------------------------------	---	---

Voltage		
Indoor - Outdoor S1-S2	AC	208 / 230V
Indoor - Outdoor S2-S3		+/- 24VDC

External Static Pressure	In. WG	0.30 - 0.50 - 0.80
--------------------------	--------	--------------------

External Finish	High-gloss polyester powder coated	
-----------------	------------------------------------	--

External Dimensions (H x W x D)	In.(mm)	50-1/4 x 17 x 21-5/8 (1,275 x 432 x 548)
---------------------------------	---------	---

Net Weight	Lbs.(kg)	113 (51)
------------	----------	----------

Sound Pressure Level (Low-Mid-Hi)		
Cooling	dB(A)	28 - 32 - 36
Heating		28 - 32 - 36

Airflow Rate (Low-Mid-Hi)		
Cooling (Dry)	CFM	410 - 497 - 585
Heating		410 - 497 - 585

Refrigerant Piping		
Liquid (High Pressure)	In.(mm)	1/4 (6.35)
Gas (Low Pressure)		1/2 (12.70)

Refrigerant	R410A	
-------------	-------	--

Connection Method	Flared	
-------------------	--------	--

### GENERAL FEATURES:

- Multi-position air handling unit
- Multi-Position installation without any additional kits
- Quiet operation
- Selectable external static pressure settings with capabilities up to 0.80 In. W.G.
- Auto fan speed control: Low, Medium, High
- Indoor unit powered from outdoor unit using A-Control (Optional)
- Auto restart following a power outage
- Limited warranty: five years parts and seven years compressors

### ACCESSORIES:

- Mini-Condensation Pump (SI30-115/230)
- Maxi Blue Diamond Condensate Pump 230V (X87-721)

# DIMENSIONS: MVZ-A18AA4

Unit: inch

Model	A	B	C	D	E	F	G	H	J	① Gas pipe	② Liquid pipe
WZ-A12AA4	432	376	281	224	1275	680	823	735.5	380	①12.7 (1/2)	②6.35 (1/4)
WZ-A18AA4	(17)	(14-13/16)	(11-1/8)	(8-7/8)	(50-1/4)	(28-13/16)	(32-1/8)	(29)	(14-3/16)	①15.88 (5/8)	②9.52 (3/8)
WZ-A24AA4	534	477	382.6	266.5	1378	737	953.5	792	461	①15.88 (5/8)	②9.52 (3/8)
WZ-A30AA4	(21)	(18-13/16)	(15-1/8)	(10-1/2)	(54-1/4)	(29-1/8)	(37-9/16)	(31-3/8)	(18-3/16)	①15.88 (5/8)	②9.52 (3/8)

Unit:mm(In.)

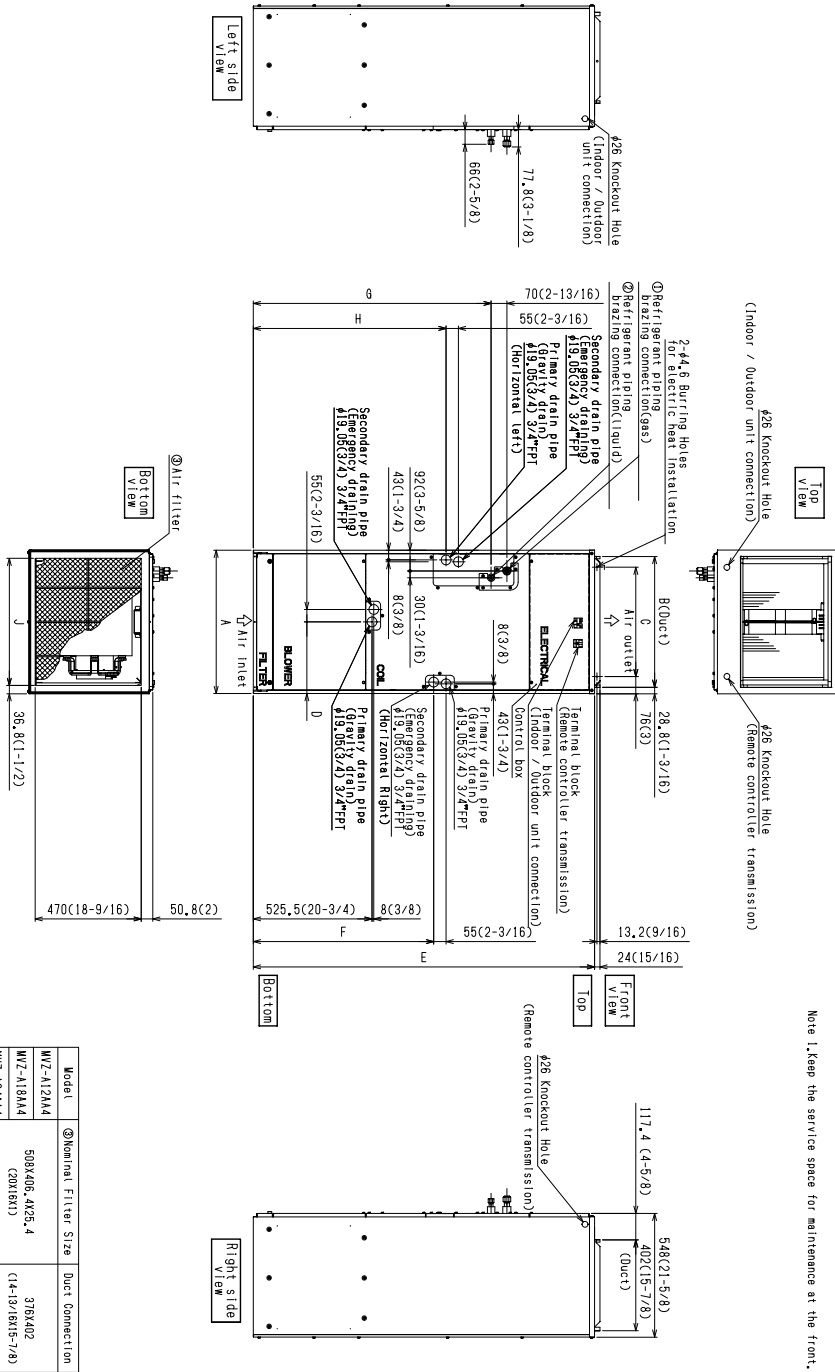

Note 1. Keep the service space for maintenance at the front.

Model	①Nominal Filter Size	Duct Connection
WZ-A12AA4	509X406, 4X28, 4	376X402 (20X16X1)
WZ-A18AA4	509X406, 4X28, 4	(14-13/16)X(15-7/8)
WZ-A24AA4	509X406, 4X28, 4	477X402 (20X20X1)
WZ-A30AA4	509X406, 4X28, 4	(18-13/16)X(15-7/8)



COOLING & HEATING  
1340 Satellite Boulevard, Suwanee, GA 30024  
Toll Free: 800-433-4822 www.mehvac.com



Job Name:	Date:
System Reference:	



MVZ-A24AA4

### SPECIFICATIONS:

Rated Capacity*		
Cooling	Btu/h	24,000
Heating at 47° F	Btu/h	27,000

\*Rating Conditions per AHRI Standard:  
 Cooling | Indoor: 80° F (27° C) DB / 67° F (19° C) WB  
 Cooling | Outdoor: 95° F (35° C) DB / 75° F (24° C) WB  
 Heating at 47°F | Indoor: 70° F (21° C) DB / 60° F (16° C) WB  
 Heating at 47°F | Outdoor: 47° F (8° C) DB / 43° F (6° C) WB

For data on specific indoor units (all ducted, all non-ducted, and both ducted and non-ducted) combinations, see the MXZ Technical and Service Manual

Electrical Power Requirements	208 / 230V, 1-Phase, 60 Hz	
-------------------------------	----------------------------	--

Minimum Circuit Ampacity (MCA)	A	1
--------------------------------	---	---

Voltage		
Indoor - Outdoor S1-S2	AC	208 / 230V
Indoor - Outdoor S2-S3		+/- 24VDC

External Static Pressure	In. WG	0.30 - 0.50 - 0.80
--------------------------	--------	--------------------

External Finish	High-gloss polyester powder coated	
-----------------	------------------------------------	--

External Dimensions (H x W x D)	In.(mm)	50-1/4 x 17 x 21-5/8 (1,275 x 432 x 548)
---------------------------------	---------	---

Net Weight	Lbs.(kg)	113 (51)
------------	----------	----------

Sound Pressure Level (Low-Mid-Hi)		
Cooling	dB(A)	30 - 34 - 38
Heating		30 - 34 - 38

Airflow Rate (Low-Mid-Hi)		
Cooling (Dry)	CFM	515 - 625 - 735
Heating		515 - 625 - 735

Refrigerant Piping		
Liquid (High Pressure)	In.(mm)	3/8 (9.52)
Gas (Low Pressure)		5/8 (15.88)

Refrigerant	R410A	
-------------	-------	--

Connection Method	Flared	
-------------------	--------	--

### GENERAL FEATURES:

- Multi-position air handling unit
- Multi-Position installation without any additional kits
- Quiet operation
- Selectable external static pressure settings with capabilities up to 0.80 In. W.G.
- Auto fan speed control: Low, Medium, High
- Indoor unit powered from outdoor unit using A-Control (Optional)
- Auto restart following a power outage
- Limited warranty: five years parts and seven years compressors

### ACCESSORIES:

- Mini-Condensation Pump (SI30-115/230)
- Maxi Blue Diamond Condensate Pump 230V (X87-721)



Job Name:	Date:
System Reference:	



MVZ-A30AA4

### SPECIFICATIONS:

Rated Capacity*		
Cooling	Btu/h	30,000
Heating at 47° F	Btu/h	34,000

\*Rating Conditions per AHRI Standard:  
 Cooling | Indoor: 80° F (27° C) DB / 67° F (19° C) WB  
 Cooling | Outdoor: 95° F (35° C) DB / 75° F (24° C) WB  
 Heating at 47°F | Indoor: 70° F (21° C) DB / 60° F (16° C) WB  
 Heating at 47°F | Outdoor: 47° F (8° C) DB / 43° F (6° C) WB

For data on specific indoor units (all ducted, all non-ducted, and both ducted and non-ducted) combinations, see the MXZ Technical and Service Manual

Electrical Power Requirements	208 / 230V, 1-Phase, 60 Hz	
-------------------------------	----------------------------	--

Minimum Circuit Ampacity (MCA)	A	1
--------------------------------	---	---

Voltage		
Indoor - Outdoor S1-S2	AC	208 / 230V
Indoor - Outdoor S2-S3		+/- 24VDC

External Static Pressure	In. WG	0.30 - 0.50 - 0.80
--------------------------	--------	--------------------

External Finish	High-gloss polyester powder coated	
-----------------	------------------------------------	--

External Dimensions (H x W x D)	In.(mm)	54-1/4 x 21 x 21-5/8 (1,378 x 534 x 548)
---------------------------------	---------	---

Net Weight	Lbs.(kg)	141 (64)
------------	----------	----------

Sound Pressure Level (Low-Mid-Hi)		
Cooling	dB(A)	32 - 36 - 40
Heating		32 - 36 - 40

Airflow Rate (Low-Mid-Hi)		
Cooling (Dry)	CFM	613 - 744 - 875
Heating		613 - 744 - 875

Refrigerant Piping		
Liquid (High Pressure)	In.(mm)	3/8 (9.52)
Gas (Low Pressure)		5/8 (15.88)

Refrigerant	R410A	
-------------	-------	--

Connection Method	Flared	
-------------------	--------	--

### GENERAL FEATURES:

- Multi-position air handling unit
- Multi-Position installation without any additional kits
- Quiet operation
- Selectable external static pressure settings with capabilities up to 0.80 In. W.G.
- Auto fan speed control: Low, Medium, High
- Indoor unit powered from outdoor unit using A-Control (Optional)
- Auto restart following a power outage
- Limited warranty: five years parts and seven years compressors

### ACCESSORIES:

- Mini-Condensation Pump (SI30-115/230)
- Maxi Blue Diamond Condensate Pump 230V (X87-721)

# DIMENSIONS: MVZ-A30AA4

Unit: inch

Model	A	B	C	D	E	F	G	H	J	① Gas pipe	② Liquid pipe
WZ-A12AA4	432	376	281	224	1275	680	823	735.5	380	①12.7 (1/2)	②6.35 (1/4)
WZ-A18AA4	(17)	(14-13/16)	(11-1/8)	(8-7/8)	(50-1/4)	(28-13/16)	(32-1/8)	(29)	(14-3/16)	①15.88 (5/8)	②9.52 (3/8)
WZ-A24AA4	534	477	382.6	266.5	1378	737	953.5	792	461	①15.88 (5/8)	②9.52 (3/8)
WZ-A30AA4	(21)	(18-13/16)	(15-1/8)	(10-1/2)	(54-1/4)	(29-1/8)	(37-9/16)	(31-3/8)	(18-3/16)	①15.88 (5/8)	②9.52 (3/8)

Unit:mm(In.)

Model	③ Nominal Filter Size	Duct Connection
WZ-A12AA4	509X406, 4X28_4	376X402
WZ-A18AA4	(20X181)	(14-13/16)X(15-7/8)
WZ-A24AA4	509X508X25_4	477X402
WZ-A30AA4	(20X201)	(18-13/16)X(15-7/8)

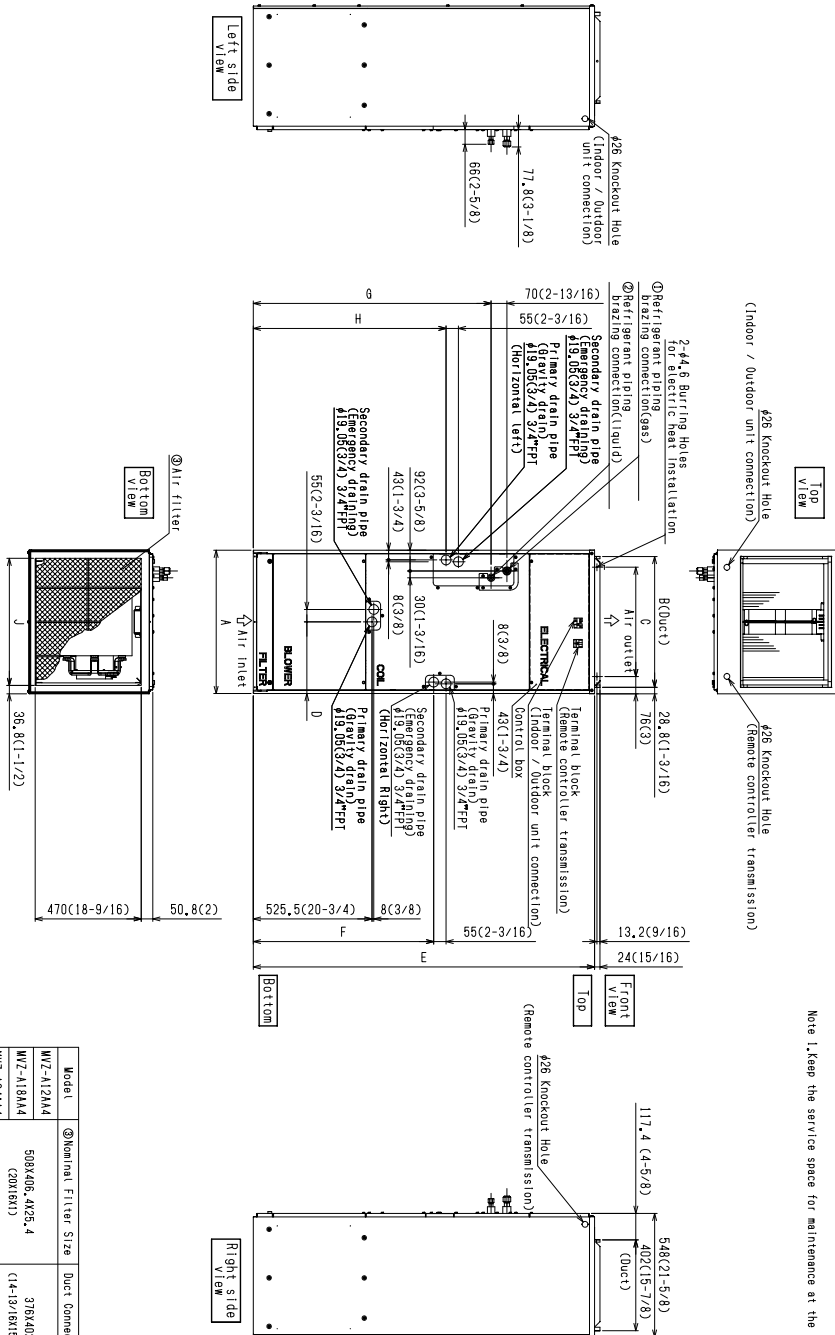

Note 1. Keep the service space for maintenance at the front.



COOLING & HEATING  
 1340 Satellite Boulevard, Suwanee, GA 30024  
 Toll Free: 800-433-4822 www.mehvac.com





Job Name:	Date:
System Reference:	



MVZ-A36AA4

### SPECIFICATIONS:

Rated Capacity*		
Cooling	Btu/h	36,000
Heating at 47° F	Btu/h	40,000

\*Rating Conditions per AHRI Standard:  
 Cooling | Indoor: 80° F (27° C) DB / 67° F (19° C) WB  
 Cooling | Outdoor: 95° F (35° C) DB / 75° F (24° C) WB  
 Heating at 47°F | Indoor: 70° F (21° C) DB / 60° F (16° C) WB  
 Heating at 47°F | Outdoor: 47° F (8° C) DB / 43° F (6° C) WB

For data on specific indoor units (all ducted, all non-ducted, and both ducted and non-ducted) combinations, see the MXZ Technical and Service Manual

Electrical Power Requirements	208 / 230V, 1-Phase, 60 Hz	
-------------------------------	----------------------------	--

Minimum Circuit Ampacity (MCA)	A	1
--------------------------------	---	---

Voltage		
---------	--	--

Indoor - Outdoor S1-S2	AC 208 / 230V	
Indoor - Outdoor S2-S3	+/- 24VDC	

External Static Pressure	In. WG	0.30 - 0.50 - 0.80
--------------------------	--------	--------------------

External Finish	High-gloss polyester powder coated	
-----------------	------------------------------------	--

External Dimensions (H x W x D)	In.(mm)	54-1/4 x 21 x 21-5/8 (1,378 x 534 x 548)
---------------------------------	---------	---

Net Weight	Lbs.(kg)	141 (64)
------------	----------	----------

Sound Pressure Level (Low-Mid-Hi)		
-----------------------------------	--	--

Cooling	dB(A)	35 - 39 - 43
Heating		35 - 39 - 43

Airflow Rate (Low-Mid-Hi)		
---------------------------	--	--

Cooling (Dry)	CFM	767 - 931 - 1095
Heating		767 - 931 - 1095

Refrigerant Piping		
--------------------	--	--

Liquid (High Pressure)	In.(mm)	3/8 (9.52)
Gas (Low Pressure)		5/8 (15.88)

Refrigerant	R410A	
-------------	-------	--

Connection Method	Flared	
-------------------	--------	--

### GENERAL FEATURES:

- Multi-position air handling unit
- Multi-Position installation without any additional kits
- Quiet operation
- Selectable external static pressure settings with capabilities up to 0.80 In. W.G.
- Auto fan speed control: Low, Medium, High
- Indoor unit powered from outdoor unit using A-Control (Optional)
- Auto restart following a power outage
- Limited warranty: five years parts and seven years compressors

### ACCESSORIES:

- Mini-Condensation Pump (SI30-115/230)
- Maxi Blue Diamond Condensate Pump 230V (X87-721)

# DIMENSIONS: MVZ-A36AA4

Unit: inch

Model	A	B	C	D	E	F	G	H	J	① Gas pipe	② Liquid pipe
WZ-A12AA4	432	376	281	224	1275	680	823	735.5	380	①12.7 (1/2)	②6.35 (1/4)
WZ-A18AA4	(17)	(14-13/16)	(11-1/8)	(8-7/8)	(50-1/4)	(28-13/16)	(32-1/8)	(29)	(14-3/16)		
WZ-A24AA4	534	477	382.6	266.5	1378	737	953.5	792	461	①15.88 (5/8)	②9.52 (3/8)
WZ-A30AA4	(21)	(18-13/16)	(15-1/8)	(10-1/2)	(54-1/4)	(29-1/8)	(37-9/16)	(31-3/8)	(18-3/16)		

Unit:mm(In.)

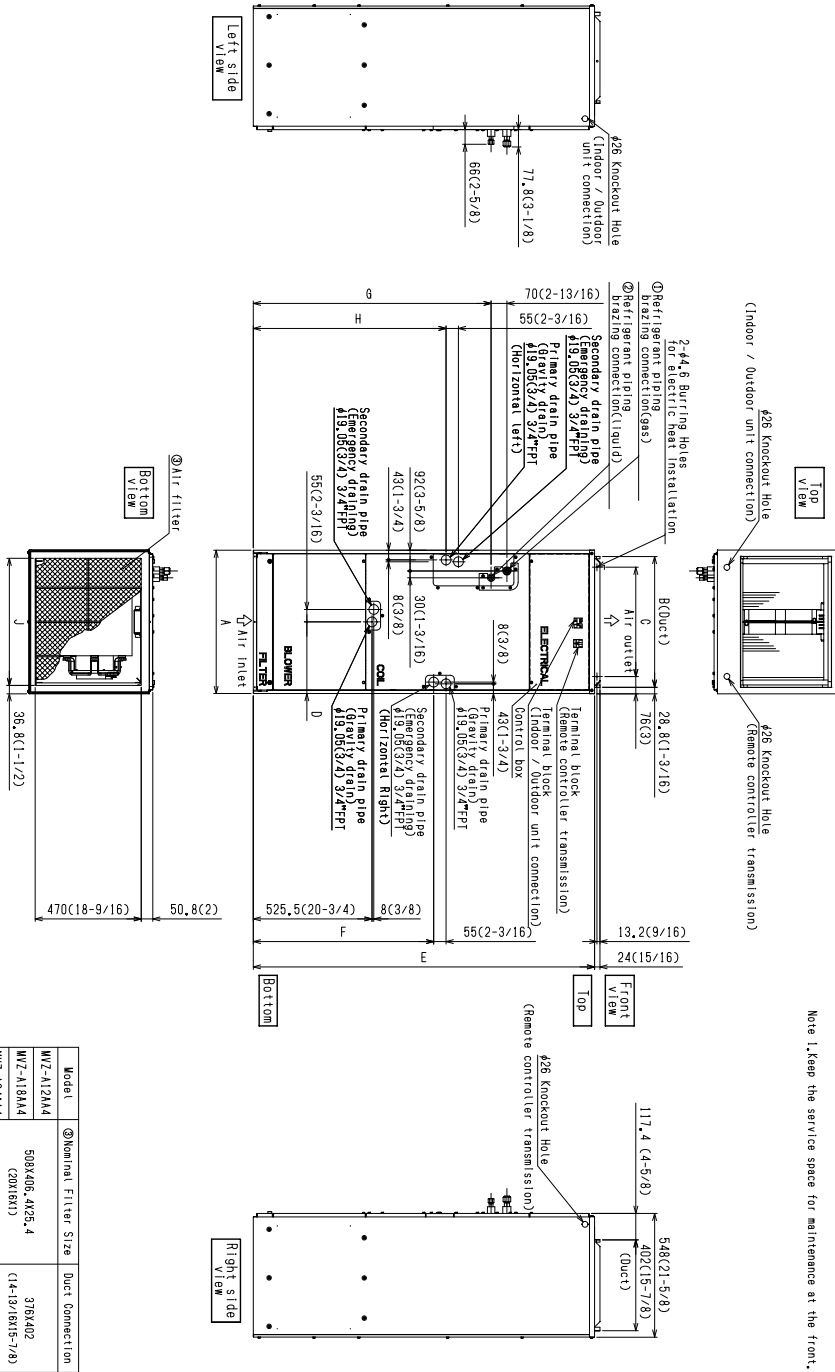

Note 1. Keep the service space for maintenance at the front.

Model	① Nominal Filter Size	Duct Connection
WZ-A12AA4	509X406, 4X26, 4	376X402
WZ-A18AA4	(20X161)	(14-13/16)X(15-7/8)
WZ-A24AA4	509X508X25, 4	477X402
WZ-A30AA4	(20X201)	(18-13/16)X(15-7/8)



COOLING & HEATING  
1340 Satellite Boulevard, Suwanee, GA 30024  
Toll Free: 800-433-4822 www.mehvac.com

