





SUBMITTAL DATA: FLEXX24HP230V1BH / FLEXX36AC230V1AO		24000 BTU/H Unitary Cooling Only Split System
Job Name	Location	Date
Purchaser	Engineer	
Submitted To	For	
Unit Designation	Schedule No.	

FLEXX24HP230V1BH	FLEXX36AC230V1AO
	
GENERAL FEATURES	

High Efficiency DC Inverter Technology
Compact and Quiet 55 dB(A) Side Discharge Outdoor Unit
Zero Lot Line Design
Match with Gree or Competitive Indoor Unit
Designed for New Construction or Replacement Market
24VAC Thermostat Compatible
8 Speed Fan Motor

Cooling Range 40°F to 118°F

Acrylic Resin/Anti-Corrosion Fin Coating (Blue - 500 Hr Salt Spray Rating)

5 Year Limited Compressor & Parts Warranty (Residential Only)

SPECIFICATIONS		FLEXX24HP230V1BH / FLEXX36AC230V1AO	
System Type		AIR CONDITIONER	
SYSTEM PERFORMANCE			
Cooling	Rated Capacity @ 95°F	Btu/h	24000
	Min-Max Capacity	Btu/h	12000 - 24000
SEER / EER		20 / 12.5	
Energy Star®		NO	
Cooling Temperature Range		°F	40 - 118
INDOOR UNIT		FLEXX24HP230V1BH	
Fan Motor Output Power		W	373
Fan Motor FLA		amps	3
Air Flow		CFM	960
Static Pressure (Rated / Maximum)		In w.c	0.1 / 1.0
Sound Pressure Level		dB(A)	45
Dehumidification		pt/hr	6.03
Condensate Drain Size (OD)		in	3 / 4
Unit Dimension (WxHxD)		in	21 1/4 x 48 1/4 x 21 1/4
Package Dimension (WxHxD)		in	26 x 50 7/16 x 23 3/4
Weight (Net / Gross)		lbs	156 / 169
Electric Heater (Optional)		kW	5, 8, 10
OUTDOOR UNIT		FLEXX36AC230V1AO	
Compressor Type		Inverter Rotary	
Compressor RLA		amps	16
Fan Motor Output Power		W	149
Fan Motor		amps	1.5
Sound Pressure Level		dB(A)	55
Unit Dimension (WxHxD)		in	32 1/4 x 37 x 18 1/8
Package Dimension (WxHxD)		in	38 3/8 x 42 11/16 x 22 9/16
Weight (Net / Gross)		lbs	217 / 240
Refrigerant Charge - R410A		oz	118.2
Coil Type (Blue Fin)		Copper Tube / Aluminum Fin	
REFRIGERANT PIPING			
Line Set Size (Liquid - Gas)		in	3/8 - 3/4
Pre-Charge Length		ft	31
Additional Charge		oz/ft	0.32
Pipe Length (Min - Max)		ft	10 - 100
Max. Pipe Elevation		ft	50
ELECTRICAL			
Power Supply (Voltage Operating Range)		208/230V / 1Ph / 60 Hz	
Outdoor Unit	Rated Current	amps	21
	MCA / MOCP	amps	24 / 35
Indoor Unit	Rated Current	amps	3
	MCA / MOCP	amps	4 / 15
Main Power Wire Size		AWG	Size Per Local Code
LIMITED WARRANTY		5 Years Parts and Compressor - Residential	

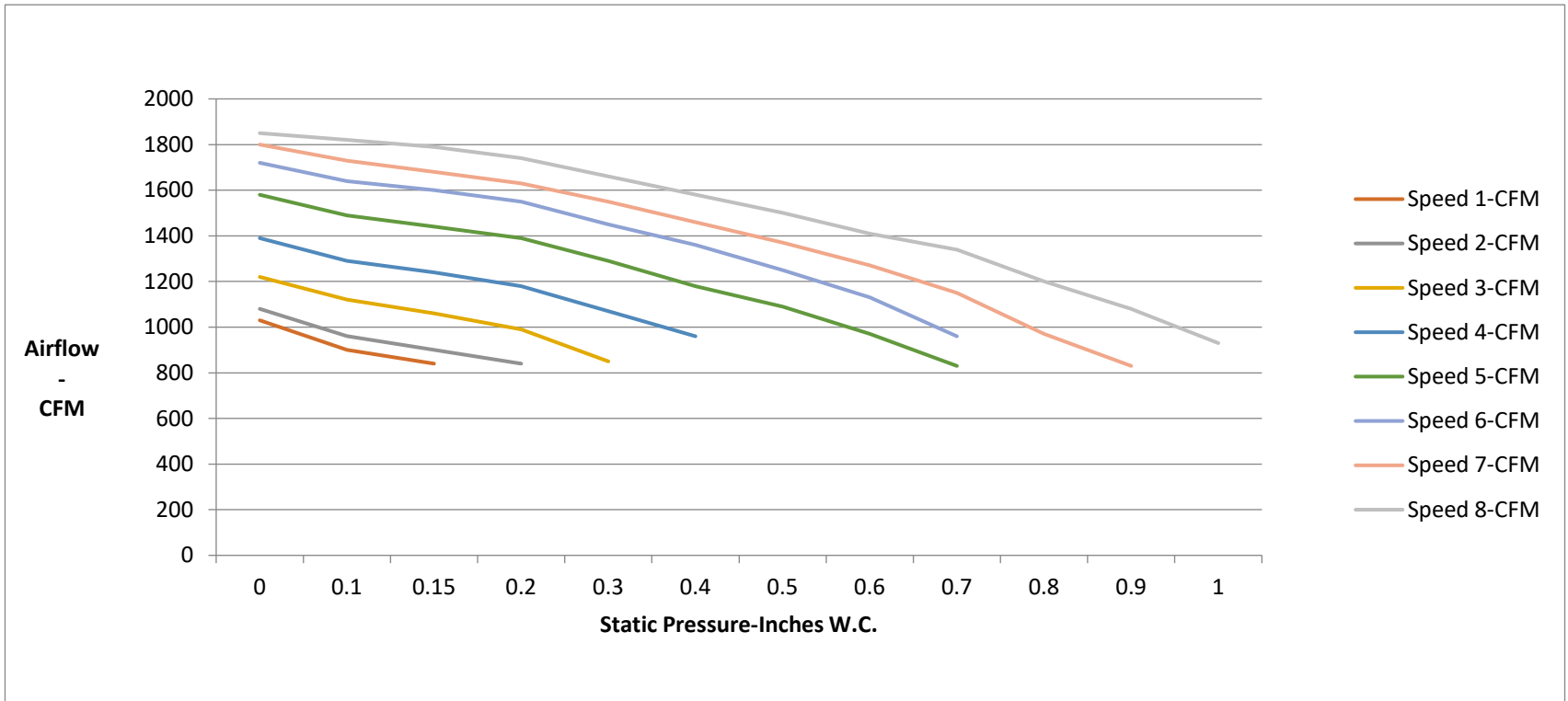

Static Pressure-Inches W.C.	0	0.1	0.15	0.2	0.3	0.4	0.5	0.6	0.7	0.8	0.9	1.0
Speed 1-CFM	1030	900	840									
Speed 2-CFM	1080	960	900	840								
Speed 3-CFM	1220	1120	1060	990	850							
Speed 4-CFM	1390	1290	1240	1180	1070	960						
Speed 5-CFM	1580	1490	1440	1390	1290	1180	1090	970	830			
Speed 6-CFM	1720	1640	1600	1550	1450	1360	1250	1130	960			
Speed 7-CFM	1800	1730	1680	1630	1550	1460	1370	1270	1150	970	830	
Speed 8-CFM	1850	1820	1790	1740	1660	1580	1500	1410	1340	1200	1080	930

COOLING PERFORMANCE					
Outdoor Ambient Temperature (DB)		Return Air Temperature			
		80°F (DB)			
		TC (Btu/h)	SHR	EER	Power Input (W)
MAX OUTPUT	40°F	24000	79.5%	19.2	1250
	45°F	24000	79.2%	18.5	1300
	50°F	24000	78.5%	17.8	1350
	55°F	24000	78.8%	17.5	1375
	60°F	24000	79.0%	17.1	1400
	65°F	24000	80.0%	16.8	1430
	70°F	24000	79.5%	16.3	1470
	75°F	24000	79.8%	15.9	1510
	80°F	25000	78.4%	14.9	1680
	85°F	25000	79.5%	13.5	1850
	90°F	25000	79.7%	12.6	1980
	95°F	25000	80.0%	11.7	2130
	100°F	24000	78.8%	11.0	2190
	105°F	24000	79.0%	10.3	2320
	110°F	24000	79.0%	9.7	2480
115°F	24000	81.0%	9.0	2680	
118°F	23000	76.6%	8.3	2780	

LEGEND: W - Watts
 DB - Dry Bulb
 TC - Total Capacity
 SHR - Sensible Heat Ratio

SYSTEM FEATURES	
Inverter Type	G10
Ultra Low Frequency Torque Control	Yes
Power Factor Correction	Yes
Compressor Type	Rotary
Basepan With Electric Heater	No
Indoor & Outdoor Fin Coating	Yes
Low Voltage Startup	Yes
Memory/Power Failure Recovery	Yes
Self Diagnosis	Yes
Smart Thermostat / 24V Thermostat Compatible	Yes
Wired Controller Interface	No
WiFi Included	No
Indoor Fan Type	Centrifugal
Multi Fan Speeds	8
Rated External Static Pressure	0.1
External Static Pressure (Min - Max)	0 - 1.0
Indoor Unit Display	No
Auxiliary Electrical Heater	Optional
Ventilation (Outdoor Air)	No

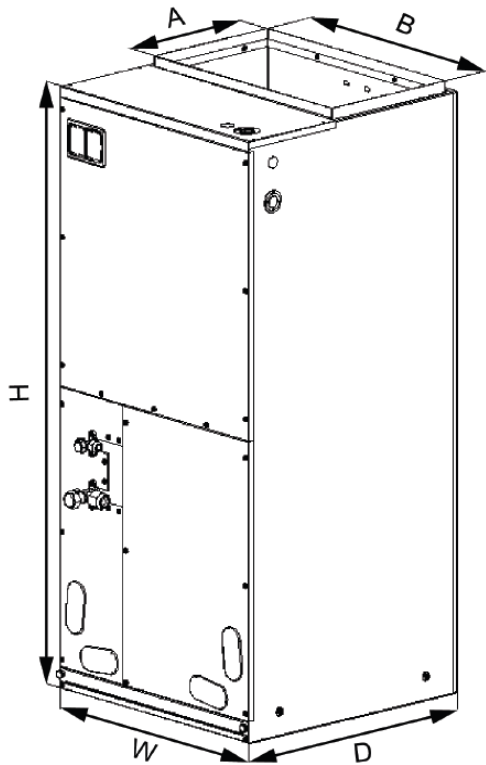

Dimensions	
A	11 5/8
B	20
H	48 1/4
W	21 1/4
D	21 1/4

Filter Size	
Supplied*	19 1/4 x 20 1/4 x 1/2
Suggested	19 1/4 x 20 1/4 x 1

*Supplied filter is metal mesh

Clearances	
Front	> 24

Allow a minimum of 24" in front of the unit for service clearance. When installing in an area directly over a finished ceiling (such as an attic), an emergency drain pan is required directly under the unit. **See local and state codes for requirements.** When installing this unit in an area that may become wet, elevate the unit with a sturdy, non-porous material. In installations that may lead to physical damage (i.e. a garage) it is advised to install a protective barrier to prevent such damage. This air handler is designed for a complete supply and return ductwork system.

Multi-Position Capabilities

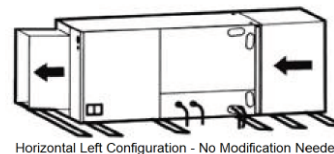
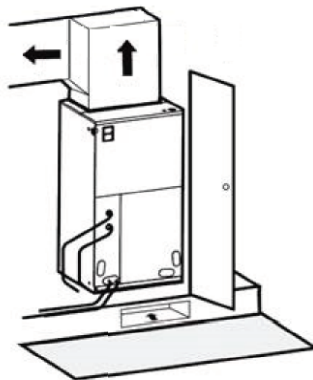

Horizontal Left Configuration - No Modification Needed

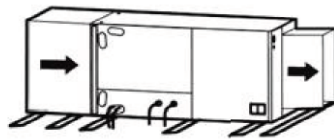

Horizontal Right Configuration - Must Relocate Drain Pan

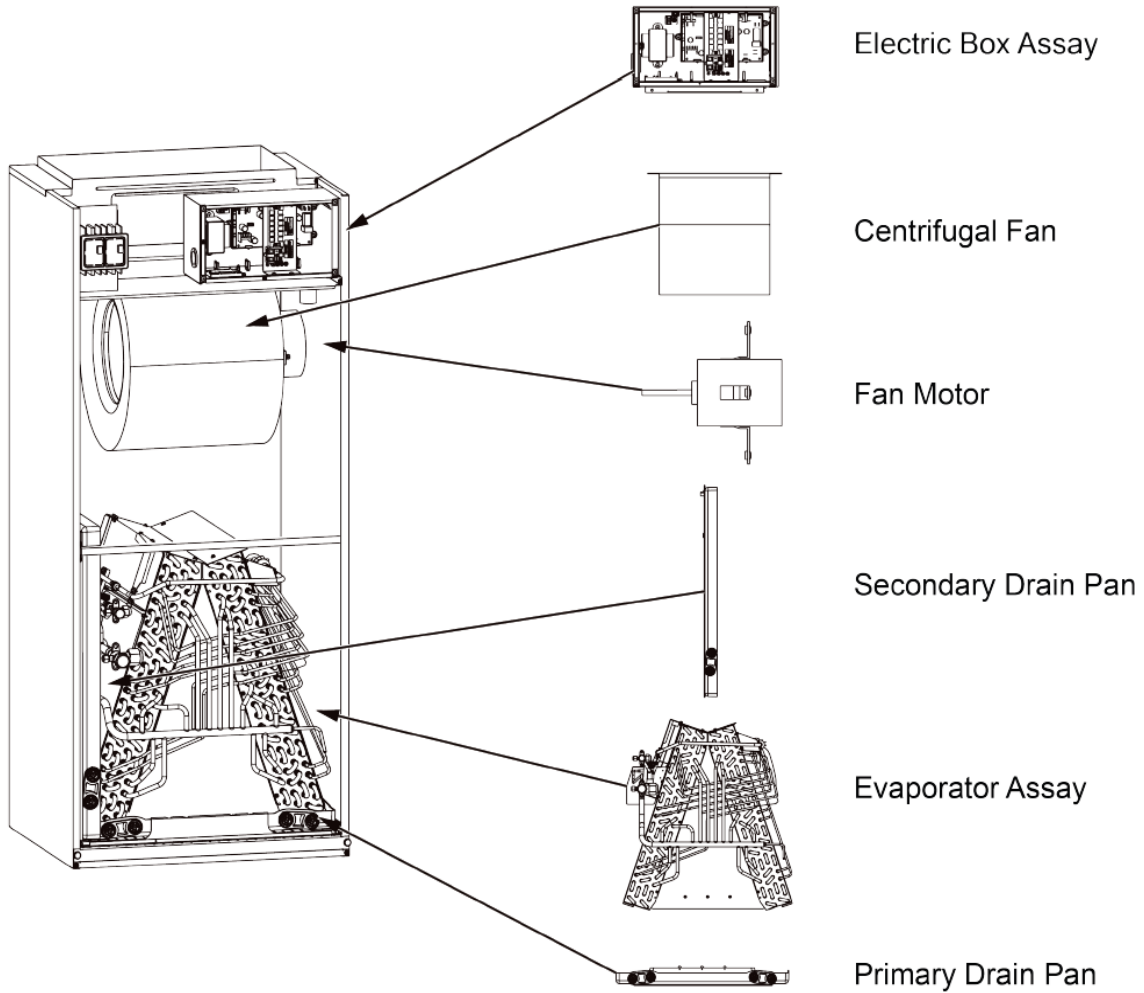

Model	Heat Kit Model	Electric Heat (kW)		Min. Circuit		Max.Fuse or Breaker	
		240V	208V	240V	208V	240V	208V
FLEXX24HP230V1BH	FLEXXHTR5KW	5	3.76	26	22.6	30	25
	FLEXXHTR8KW	8	6	41.7	36	45	40
	21-4227-00	5	3.76	26	22.6	30	25
	21-4216-00	8	6	41.7	36	45	40

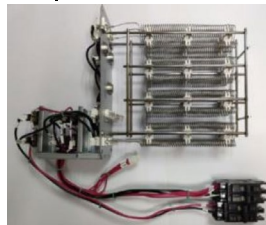

DIMENSIONS & CLEARANCES

FLEXX36AC230V1AO

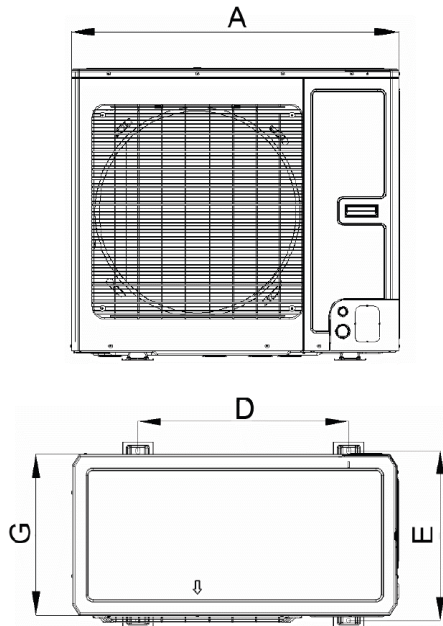

Dimensions	
A	37
B	20 1/8
C	32 1/4
D	24
E	19 1/8
G	18 1/8

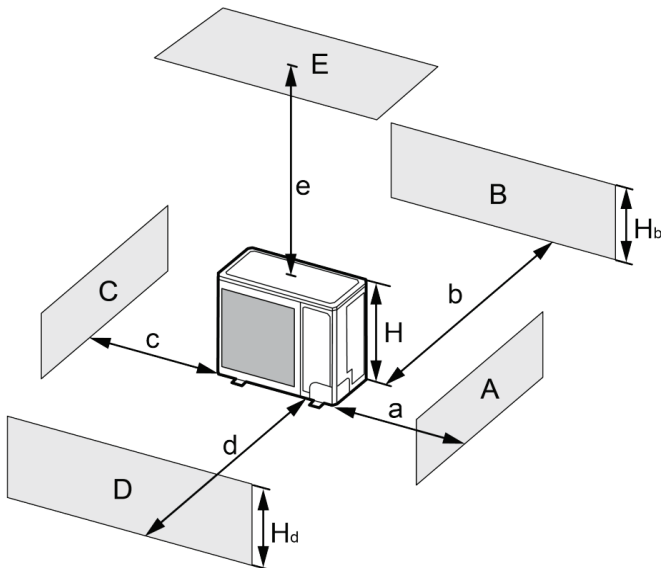

A~E	H _b	H _d	H	(in)				
				a	b	c	d	e
B	—	—	—	-	≥ 4	-	-	-
A,B,C,	—	—	—	≥ 12	≥ 4	≥ 4	-	-
B,E	—	—	—	-	≥ 4	-	-	≥ 40
A,B,C,E	—	—	—	≥ 12	≥ 6	≥ 6	-	≥ 40
D	—	—	—	-	-	-	≥ 40	-
D,E	—	—	—	-	-	-	≥ 40	≥ 40
B,D	H _b < H _d	H _d > H	—	-	≥ 4	-	≥ 40	-
	H _b > H _d	H _d < H	—	-	≥ 4	-	≥ 40	-
B,D,E	H _b < H _d	H _b ≤ 1/2H	—	≥ 10	-	≥ 80	≥ 40	
		1/2H < H _b ≤ H	—	≥ 10	-	≥ 80	≥ 40	
		H _b > H	Prohibited					
	H _b > H _d	H _d ≤ 1/2H	—	≥ 4	-	≥ 80	≥ 40	
		1/2H < H _d ≤ H	—	≥ 8	-	≥ 80	≥ 40	
		H _d > H	Prohibited					

Specifications are subject to change without notice. Manufacturer reserves the right to discontinue or modify specifications or designs without notice or without incurring obligations. All Rights reserved.



SUBMITTAL DATA: FLEXX36HP230V1BH / FLEXX36AC230V1AO 36000 BTU/H Unitary Cooling Only Split System

Job Name	Location	Date
Purchaser	Engineer	
Submitted To	For	
Unit Designation	Schedule No.	

FLEXX36HP230V1BH	FLEXX36AC230V1AO
-------------------------	-------------------------

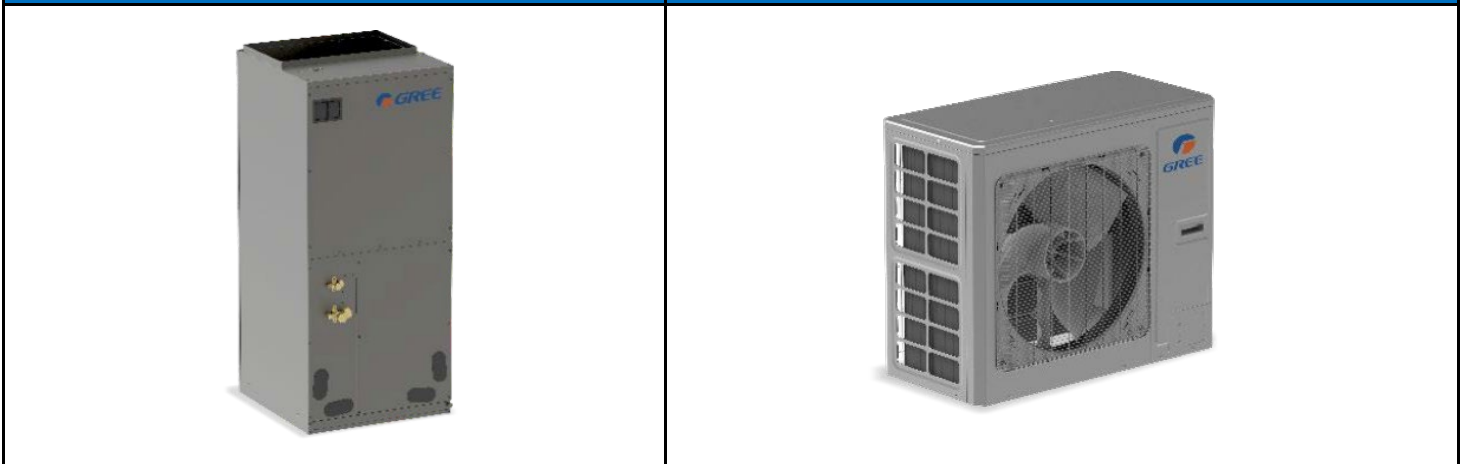

GENERAL FEATURES

- High Efficiency DC Inverter Technology**
- Compact and Quiet 55 dB(A) Side Discharge Outdoor Unit**
- Zero Lot Line Design**
- Match with Gree or Competitive Indoor Unit**
- Designed for New Construction or Replacement Market**
- 24VAC Thermostat Compatible**
- 8 Speed Fan Motor**

Cooling Range 40°F to 118°F

Acrylic Resin/Anti-Corrosion Fin Coating (Blue - 500 Hr Salt Spray Rating)

5 Year Limited Compressor & Parts Warranty (Residential Only)

SPECIFICATIONS		FLEXX36HP230V1BH / FLEXX36AC230V1AO	
System Type		COOLING ONLY	
SYSTEM PERFORMANCE			
Cooling	Rated Capacity @ 95°F	Btu/h	36000
	Min-Max Capacity	Btu/h	18000 - 37000
SEER / EER		18 / 11	
Energy Star®		NO	
Cooling Temperature Range		°F	40 - 118
INDOOR UNIT		FLEXX36HP230V1BH	
Fan Motor Output Power		W	373
Fan Motor FLA		amps	3
Air Flow (Min - Max)		CFM	1000
Static Pressure (Rated / Maximum)		In w.c	0.15 / 1.0
Sound Pressure Level		dB(A)	47
Dehumidification		pt/hr	9.68
Condensate Drain Size (OD)		in	3 / 4
Unit Dimension (WxHxD)		in	21 1/4 x 48 1/4 x 21 1/4
Package Dimension (WxHxD)		in	26 x 50 7/16 x 23 3/4
Weight (Net / Gross)		lbs	156 / 169
Electric Heater (Optional)		kW	5, 8, 10
OUTDOOR UNIT		FLEXX36AC230V1AO	
Compressor Type		Inverter Rotary	
Compressor RLA		amps	16
Fan Motor Output Power		W	149
Fan Motor		amps	1.5
Sound Pressure Level		dB(A)	57
Unit Dimension (WxHxD)		in	32 1/4 x 37 x 18 1/8
Package Dimension (WxHxD)		in	38 3/8 x 42 11/16 x 22 9/16
Weight (Net / Gross)		lbs	217 / 240
Refrigerant Charge - R410A		oz	118.2
Coil Type (Blue Fin)		Copper Tube / Aluminum Fin	
REFRIGERANT PIPING			
Line Set Size (Liquid - Gas)		in	3/8 - 3/4
Pre-Charge Length		ft	31
Additional Charge		oz/ft	0.32
Pipe Length (Min - Max)		ft	10 - 100
Max. Pipe Elevation		ft	50
ELECTRICAL			
Power Supply (Voltage Operating Range)		208/230V / 1Ph / 60 Hz	
Outdoor Unit	Rated Current	amps	21
	MCA / MOCP	amps	24 / 35
Indoor Unit	Rated Current	amps	3
	MCA / MOCP	amps	4 / 15
Main Power Wire Size		AWG	Size Per Local Code
LIMITED WARRANTY		5 Years Parts and Compressor - Residential	

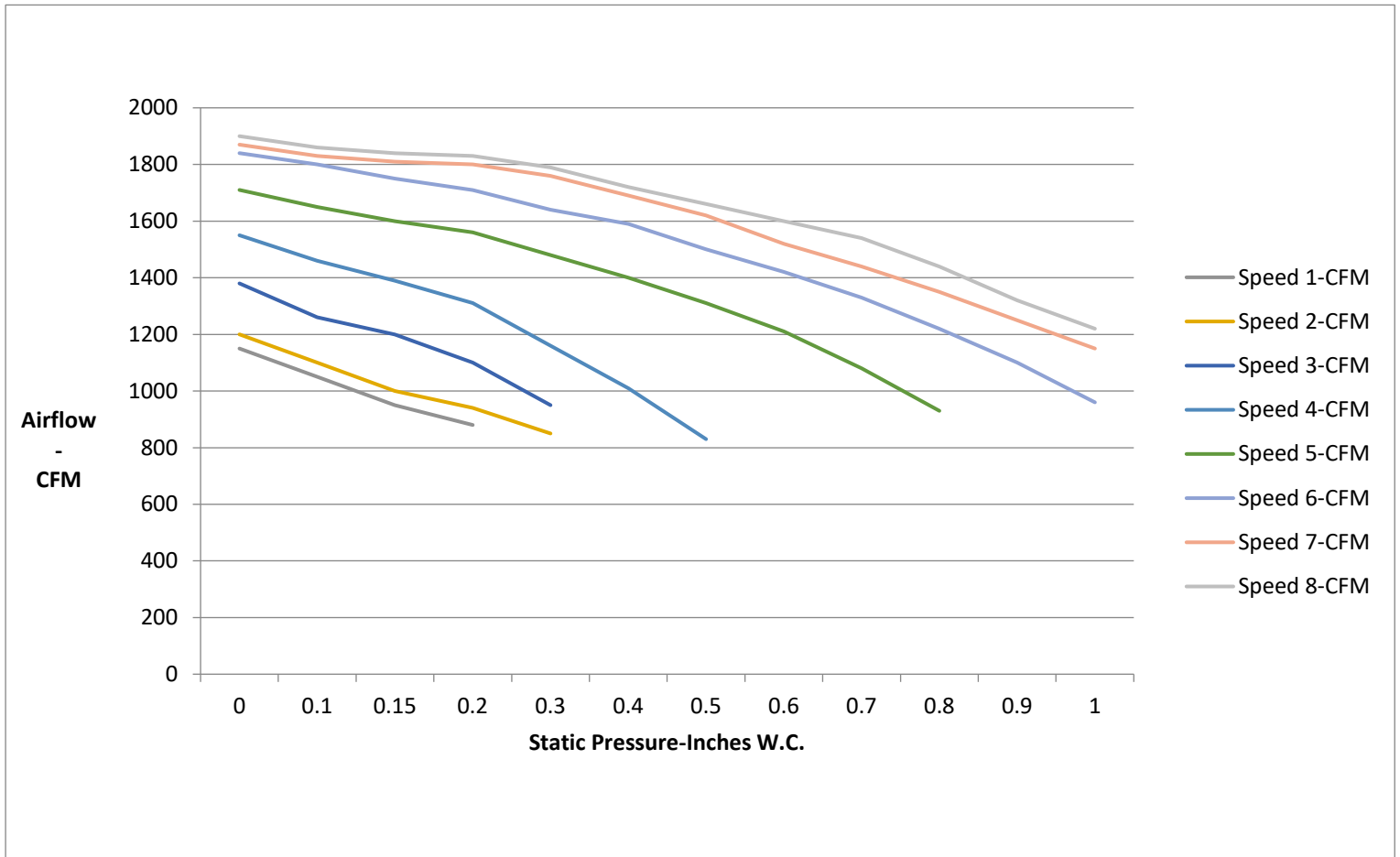

Static Pressure Inches W.C.	0	0.1	0.15	0.2	0.3	0.4	0.5	0.6	0.7	0.8	0.9	1.0
Speed 1-CFM	1150	1050	950	880								
Speed 2-CFM	1200	1100	1000	940	850							
Speed 3-CFM	1380	1260	1200	1100	950							
Speed 4-CFM	1550	1460	1390	1310	1160	1010	830					
Speed 5-CFM	1710	1650	1600	1560	1480	1400	1310	1210	1080	930		
Speed 6-CFM	1840	1800	1750	1710	1640	1590	1500	1420	1330	1220	1100	960
Speed 7-CFM	1870	1830	1810	1800	1760	1690	1620	1520	1440	1350	1250	1150
Speed 8-CFM	1900	1860	1840	1830	1790	1720	1660	1600	1540	1440	1320	1220

COOLING PERFORMANCE					
Outdoor Ambient Temperature (DB)		Return Air Temperature			
		80°F (DB)			
		TC (Btu/h)	SHR	EER	Power Input (W)
MAX OUTPUT	40°F	36000	69.5%	15.1	2380
	45°F	36000	71.2%	14.8	2430
	50°F	36000	70.0%	14.5	2480
	55°F	36000	70.8%	14.3	2510
	60°F	36000	71.0%	14.1	2550
	65°F	36000	70.0%	14.0	2580
	70°F	36000	71.5%	13.7	2630
	75°F	36000	69.8%	13.4	2680
	80°F	36000	70.4%	12.5	2880
	85°F	37000	69.5%	12.0	3080
	90°F	37000	71.7%	11.3	3280
	95°F	37000	70.0%	10.3	3580
	100°F	36000	70.8%	9.0	3980
	105°F	36000	69.0%	8.2	4380
	110°F	35000	70.9%	8.2	4280
	115°F	33000	71.0%	8.1	4080
118°F	30000	68.7%	7.9	3780	

LEGEND: W - Watts
 DB - Dry Bulb
 TC - Total Capacity
 SHR - Sensible Heat Ratio

SYSTEM FEATURES	
Inverter Type	G10
Ultra Low Frequency Torque Control	Yes
Power Factor Correction	Yes
Compressor Type	Rotary
Basepan With Electric Heater	No
Indoor & Outdoor Fin Coating	Yes
Low Voltage Startup	Yes
Memory/Power Failure Recovery	Yes
Self Diagnosis	Yes
Smart Thermostat / 24V Thermostat Compatible	Yes
Wired Controller Interface	No
WiFi Included	No
Indoor Fan Type	Centrifugal
Multi Fan Speeds	8
Rated External Static Pressure	0.1
External Static Pressure (Min - Max)	0 - 1.0
Indoor Unit Display	No
Auxiliary Electrical Heater	Optional
Ventilation (Outdoor Air)	No

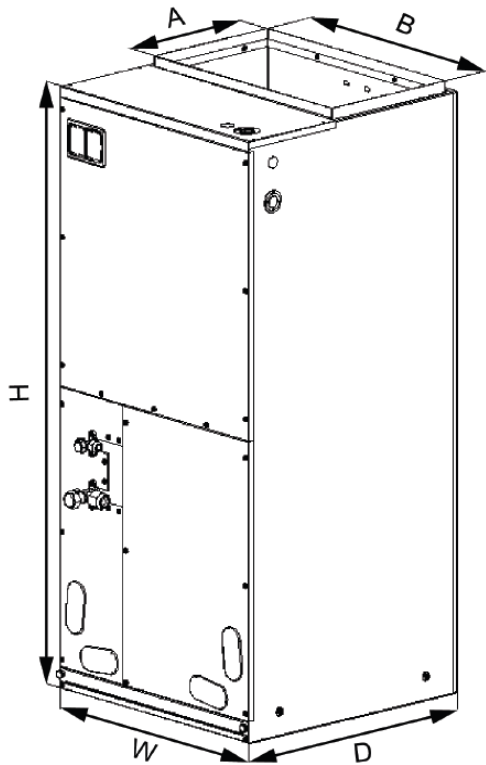

Dimensions	
A	11 5/8
B	20
H	48 1/4
W	21 1/4
D	21 1/4

Filter Size	
Supplied*	19 1/4 x 20 1/4 x 1/2
Suggested	19 1/4 x 20 1/4 x 1

*Supplied filter is metal mesh

Clearances	
Front	> 24

Allow a minimum of 24" in front of the unit for service clearance. When installing in an area directly over a finished ceiling (such as an attic), an emergency drain pan is required directly under the unit. **See local and state codes for requirements.** When installing this unit in an area that may become wet, elevate the unit with a sturdy, non-porous material. In installations that may lead to physical damage (i.e. a garage) it is advised to install a protective barrier to prevent such damage. This air handler is designed for a complete supply and return ductwork system.

Multi-Position Capabilities

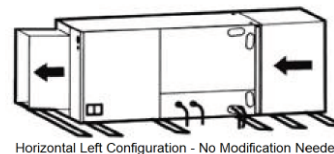
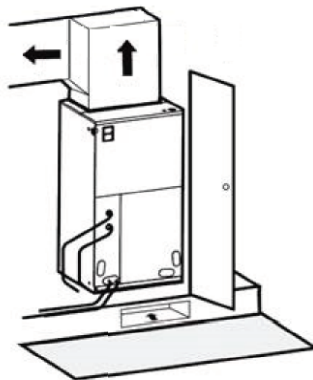

Horizontal Left Configuration - No Modification Needed

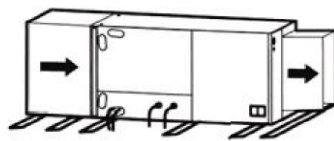

Horizontal Right Configuration - Must Relocate Drain Pan

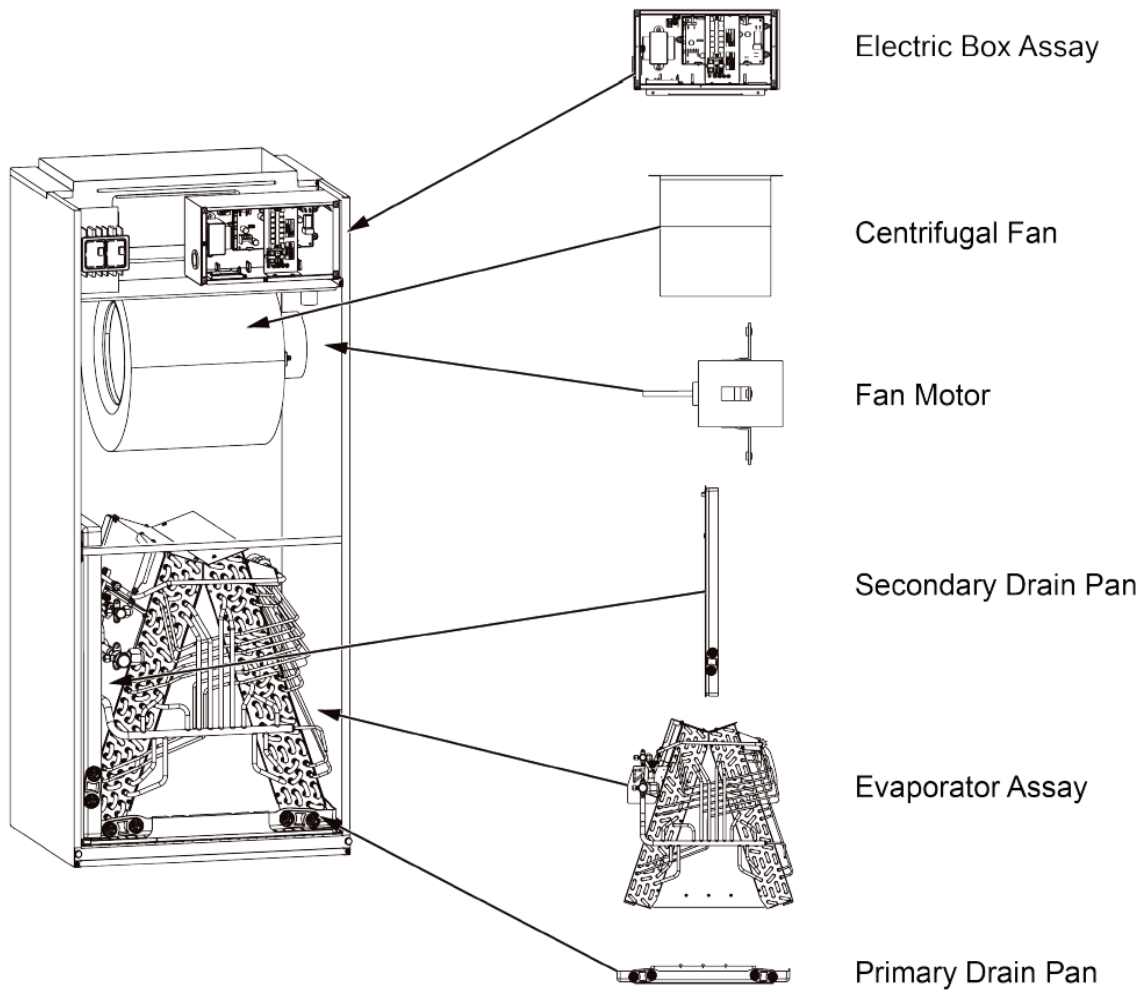

Model	Heat Kit Model	Electric Heat (kW)		Min. Circuit		Max.Fuse or Breaker	
		240V	208V	240V	208V	240V	208V
FLEXX36HP230V1BH	FLEXXHTR5KW	5	3.76	26	22.6	30	25
	FLEXXHTR8KW	8	6	41.7	36	45	40
	FLEXXHTR10KW	10	7.51	52	45	60	45
	21-4227-00	5	3.76	26	22.6	30	25
	21-4216-00	8	6	41.7	36	45	40
	21-4216-01	10	7.51	52	45	60	45



DIMENSIONS & CLEARANCES

FLEXX36AC230V1AO

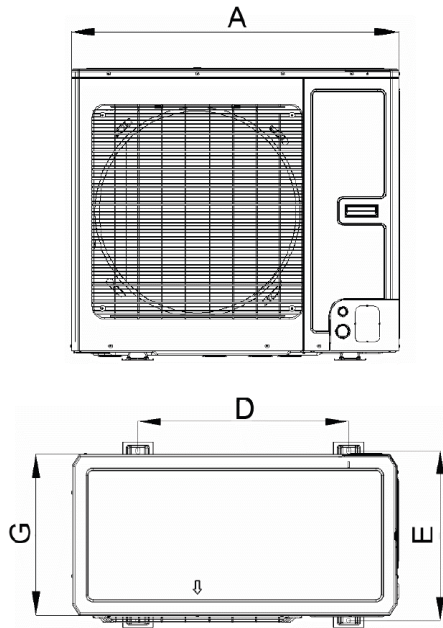

Dimensions	
A	37
B	20 1/8
C	32 1/4
D	24
E	19 1/8
G	18 1/8

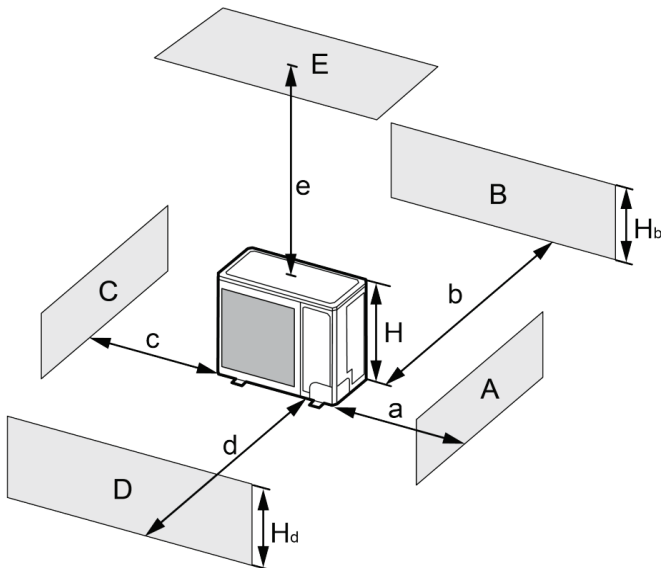

A~E	H _b	H _d	H	(in)				
				a	b	c	d	e
B	—	—	—	-	≥ 4	-	-	-
A,B,C,	—	—	—	≥ 12	≥ 4	≥ 4	-	-
B,E	—	—	—	-	≥ 4	-	-	≥ 40
A,B,C,E	—	—	—	≥ 12	≥ 6	≥ 6	-	≥ 40
D	—	—	—	-	-	-	≥ 40	-
D,E	—	—	—	-	-	-	≥ 40	≥ 40
B,D	H _b < H _d	H _d > H	—	-	≥ 4	-	≥ 40	-
	H _b > H _d	H _d < H	—	-	≥ 4	-	≥ 40	-
B,D,E	H _b < H _d	H _b ≤ 1/2H	—	-	≥ 10	-	≥ 80	≥ 40
		1/2H < H _b ≤ H	—	-	≥ 10	-	≥ 80	≥ 40
		H _b > H	Prohibited					
	H _b > H _d	H _d ≤ 1/2H	—	-	≥ 4	-	≥ 80	≥ 40
		1/2H < H _d ≤ H	—	-	≥ 8	-	≥ 80	≥ 40
		H _d > H	Prohibited					

Specifications are subject to change without notice. Manufacturer reserves the right to discontinue or modify specifications or designs without notice or without incurring obligations. All Rights reserved.



SUBMITTAL DATA: FLEXX48HP230V1BH / FLEXX60AC230V1AO 48000 BTU/H Unitary Cooling Only Split System

Job Name	Location	Date
Purchaser	Engineer	
Submitted To	For	
Unit Designation	Schedule No.	

FLEXX48HP230V1BH	FLEXX60AC230V1AO
-------------------------	-------------------------

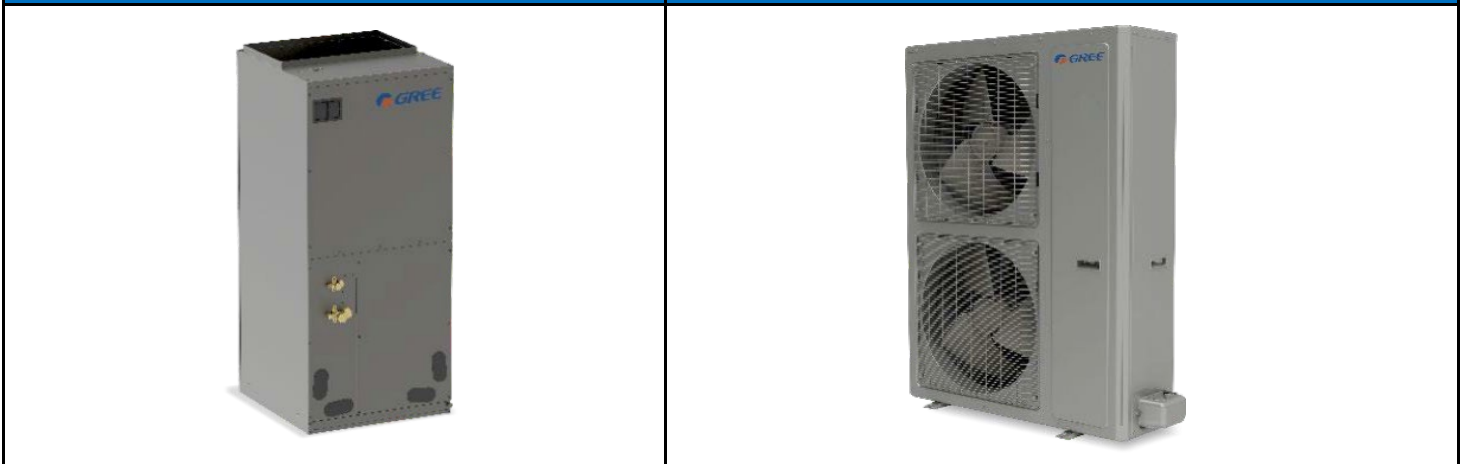

GENERAL FEATURES

- High Efficiency DC Inverter Technology**
- Compact and Quiet 55 dB(A) Side Discharge Outdoor Unit**
- Zero Lot Line Design**
- Match with Gree or Competitive Indoor Unit**
- Designed for New Construction or Replacement Market**
- 24VAC Thermostat Compatible**
- 8 Speed Fan Motor**

Cooling Range 40°F to 118°F

Acrylic Resin/Anti-Corrosion Fin Coating (Blue - 500 Hr Salt Spray Rating)

5 Year Limited Compressor & Parts Warranty (Residential Only)

SPECIFICATIONS		FLEXX48HP230V1BH / FLEXX60AC230V1AO	
System Type		COOLING ONLY	
SYSTEM PERFORMANCE			
Cooling	Rated Capacity @ 95°F	Btu/h	48000
	Min-Max Capacity	Btu/h	34000 - 48000
SEER / EER		18 / 11	
Energy Star®		NO	
Cooling Temperature Range		°F	40 - 118
INDOOR UNIT		FLEXX48HP230V1BH	
Fan Motor Output Power		W	746
Fan Motor FLA		amps	5
Air Flow (Min - Max)		CFM	1380
Static Pressure (Rated / Maximum)		In w.c	0.2 / 1.0
Sound Pressure Level		dB(A)	50
Dehumidification		pt/hr	9.94
Condensate Drain Size (OD)		in	3 / 4
Unit Dimension (WxHxD)		in	24 3/4 x 57 x 21 1/4
Package Dimension (WxHxD)		in	27 5/16 x 59 3/8 x 26
Weight (Net / Gross)		lbs	202 / 218
Electric Heater (Optional)		kW	10, 15, 20
OUTDOOR UNIT		FLEXX60AC230V1AO	
Compressor Type		Inverter Rotary	
Compressor RLA		amps	19
Fan Motor Output Power		W	149
Fan Motor (2)		amps	1.5 Ea
Sound Pressure Level		dB(A)	58
Unit Dimension (WxHxD)		in	37 1/4 x 56 1/3 x 16 3/16
Package Dimension (WxHxD)		in	40 7/8 x 62 1/4 x 17 1/4
Weight (Net / Gross)		lbs	262.4 / 288.8
Refrigerant Charge - R410A		oz	194
Coil Type (Blue Fin)		Copper Tube / Aluminum Fin	
REFRIGERANT PIPING			
Line Set Size (Liquid - Gas)		in	3/8 - 3/4
Pre-Charge Length		ft	31
Additional Charge		oz/ft	0.32
Pipe Length (Min - Max)		ft	10 - 100
Max. Pipe Elevation		ft	50
ELECTRICAL			
Power Supply (Voltage Operating Range)		208/230V / 1Ph / 60 Hz	
Outdoor Unit	Rated Current	amps	30
	MCA / MOCP	amps	35 / 45
Indoor Unit	Rated Current	amps	5
	MCA / MOCP	amps	8 / 15
Main Power Wire Size		AWG	Size Per Local Code
LIMITED WARRANTY		5 Years Parts and Compressor - Residential	

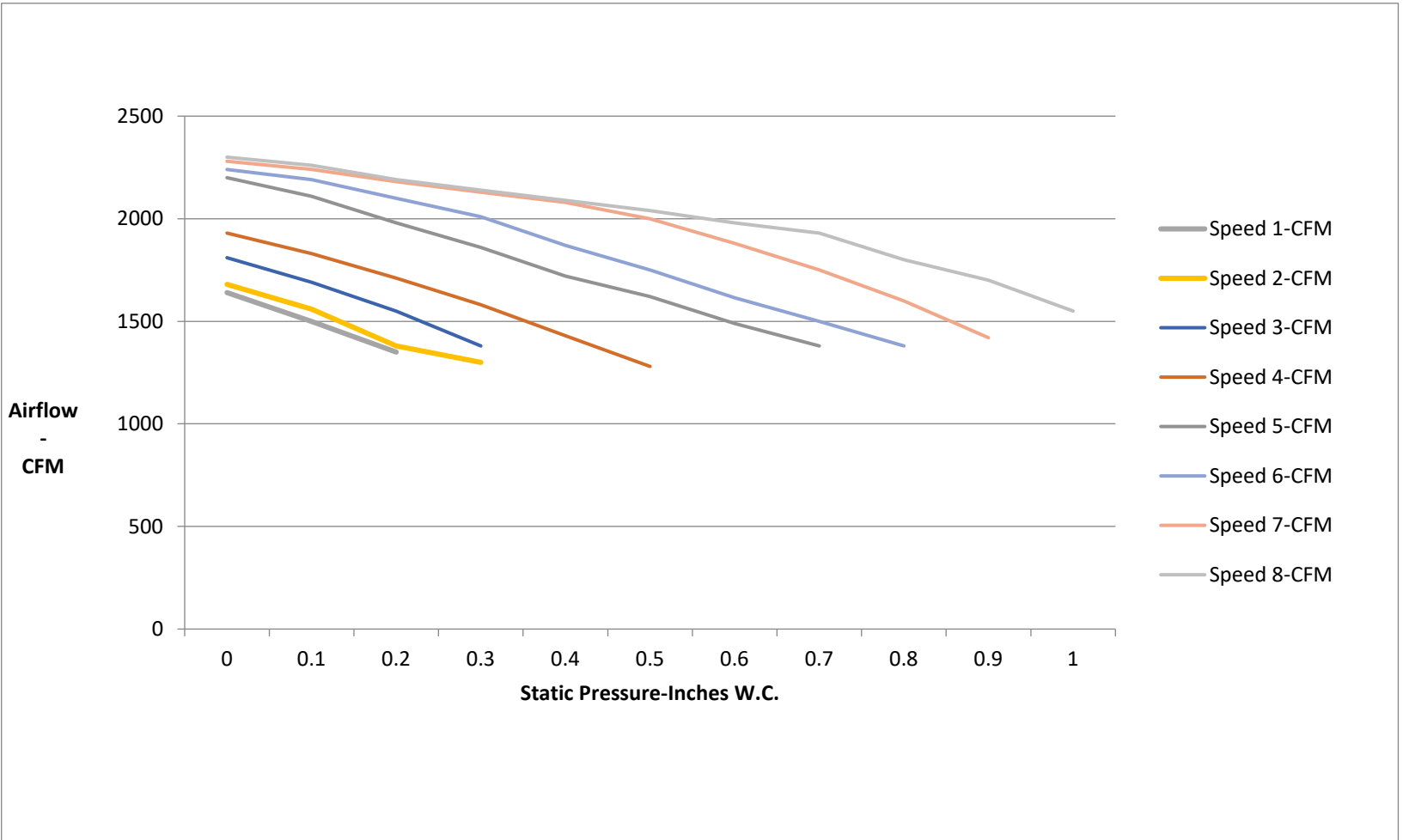

Static Pressure-Inches W.C.	0	0.1	0.15	0.2	0.3	0.4	0.5	0.6	0.7	0.8	0.9	1.0
Speed 1-CFM	1640	1500	1450	1350								
Speed 2-CFM	1680	1560	1500	1380	1300							
Speed 3-CFM	1810	1690	1620	1550	1380							
Speed 4-CFM	1930	1830	1770	1710	1580	1430	1280					
Speed 5-CFM	2200	2110	2040	1980	1860	1720	1620	1490	1380			
Speed 6-CFM	2240	2190	2145	2100	2010	1870	1750	1615	1500	1380		
Speed 7-CFM	2280	2240	2200	2180	2130	2080	2000	1880	1750	1600	1420	
Speed 8-CFM	2300	2260	2220	2190	2140	2090	2040	1980	1930	1800	1700	1550

COOLING PERFORMANCE					
Outdoor Ambient Temperature (DB)		Return Air Temperature			
		80°F (DB)			
		TC (Btu/h)	SHR	EER	Power Input (W)
MAX OUTPUT	40°F	48000	72.5%	14.9	3220
	45°F	48000	74.2%	14.6	3290
	50°F	48000	73.0%	14.3	3360
	55°F	48000	73.8%	13.9	3460
	60°F	48000	74.0%	13.4	3590
	65°F	48000	73.0%	12.9	3710
	70°F	48000	74.5%	12.8	3760
	75°F	48000	72.8%	12.6	3810
	80°F	48000	73.4%	12.2	3940
	85°F	48900	72.5%	12.0	4060
	90°F	48900	74.7%	11.2	4360
	95°F	48900	73.0%	10.4	4680
	100°F	48900	73.8%	9.9	4960
	105°F	48000	72.0%	9.1	5260
	110°F	46000	73.9%	9.1	5060
	115°F	43500	74.0%	9.0	4820
118°F	36000	71.7%	8.1	4460	

LEGEND: W - Watts
 DB - Dry Bulb
 TC - Total Capacity
 SHR - Sensible Heat Ratio

SYSTEM FEATURES	
Inverter Type	G10
Ultra Low Frequency Torque Control	Yes
Power Factor Correction	Yes
Compressor Type	Rotary
Basepan With Electric Heater	No
Indoor & Outdoor Fin Coating	Yes
Low Voltage Startup	Yes
Memory/Power Failure Recovery	Yes
Self Diagnosis	Yes
Smart Thermostat / 24V Thermostat Compatible	Yes
Wired Controller Interface	No
WiFi Included	No
Indoor Fan Type	Centrifugal
Multi Fan Speeds	8
Rated External Static Pressure	0.1
External Static Pressure (Min - Max)	0 - 1.0
Indoor Unit Display	No
Auxiliary Electrical Heater	Optional
Ventilation (Outdoor Air)	No

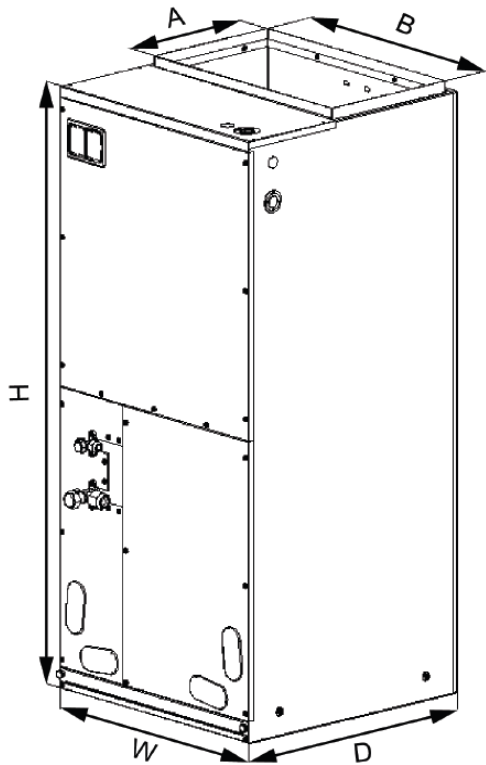

Dimensions	
A	11 5/8
B	20
H	57
W	24 3/4
D	21 1/4

Filter Size	
Supplied*	20 5/8 x 20 5/16 x 1/2
Suggested	20 5/8 x 20 5/16 x 1

*Supplied filter is metal mesh

Clearances	
Front	> 24

Allow a minimum of 24" in front of the unit for service clearance. When installing in an area directly over a finished ceiling (such as an attic), an emergency drain pan is required directly under the unit. **See local and state codes for requirements.** When installing this unit in an area that may become wet, elevate the unit with a sturdy, non-porous material. In installations that may lead to physical damage (i.e. a garage) it is advised to install a protective barrier to prevent such damage. This air handler is designed for a complete supply and return ductwork system.

Multi-Position Capabilities

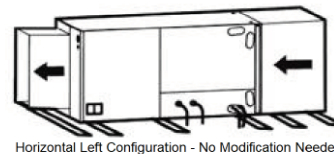
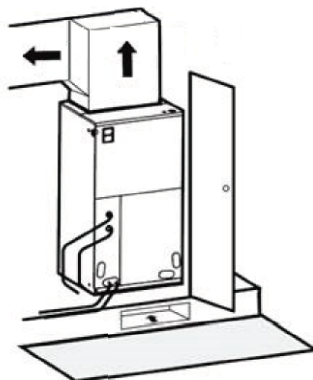

Horizontal Left Configuration - No Modification Needed

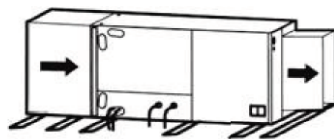

Horizontal Right Configuration - Must Relocate Drain Pan

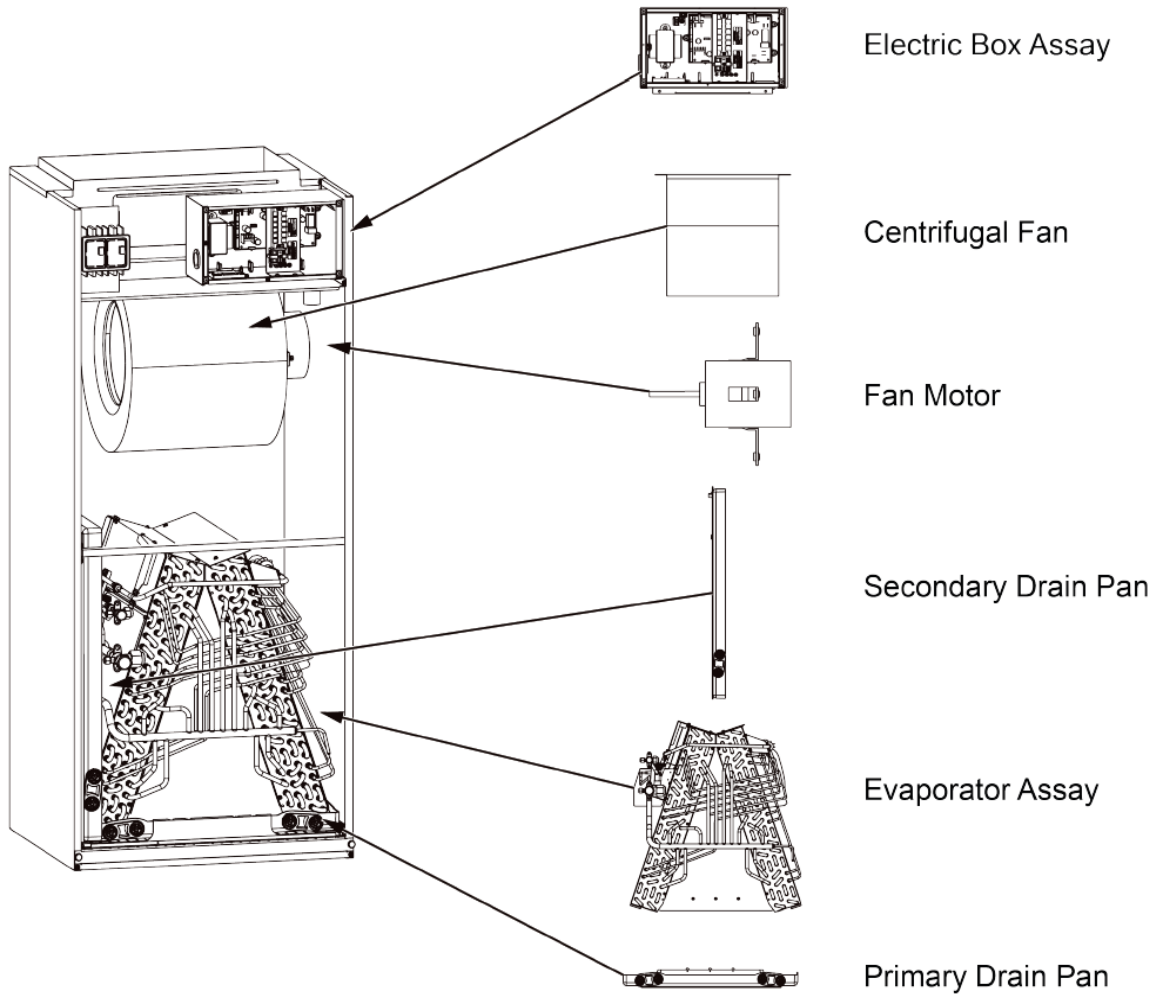

Model	Heat Kit Model	Electric Heat (kW)		Min. Circuit		Max.Fuse or Breaker	
		240V	208V	240V	208V	240V	208V
FLEXX48HP230V1BH	FLEXXHTR10KW	10	7.51	52	45	60	45
	FLEXXHTR15KW	15	11.25	52 & 26	45 & 22.6	60 & 30	45 & 25
	FLEXXHTR20KW	20	15.02	52 & 52	45 & 45	60 & 60	45 & 45
	21-4216-01	10	7.51	52	45	60	45
	21-4217-00	15	11.25	52 & 26	45 & 22.6	60 & 30	45 & 25
	21-4228-00	20	15.02	52 & 52	45 & 45	60 & 60	45 & 45

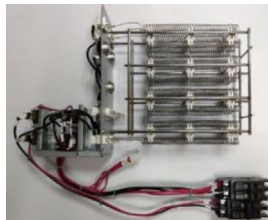

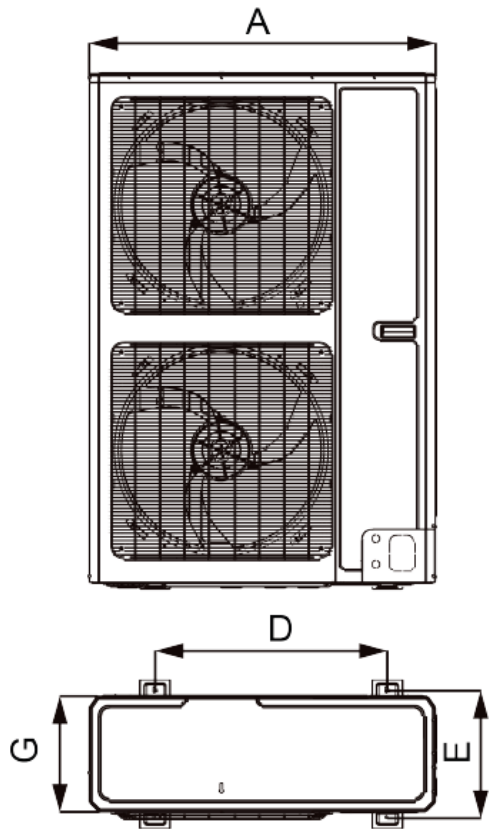

Dimensions	
A	37 1/4
B	16 3/16
C	56 1/3
D	24 7/8
E	13 7/8
G	12 5/8

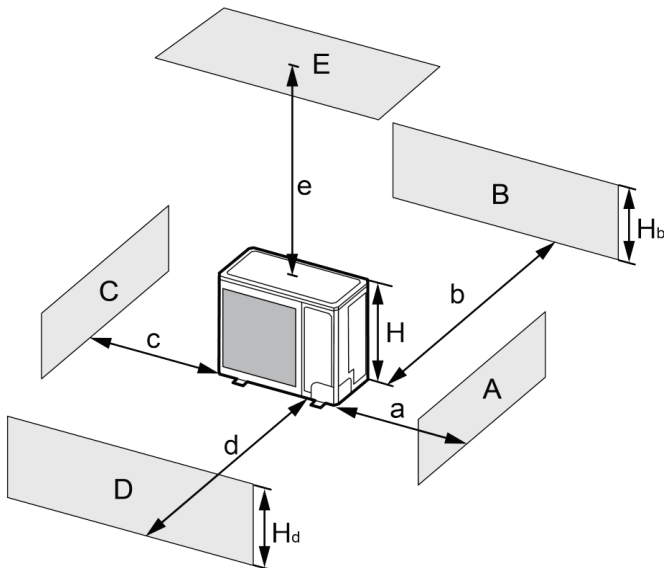

A~E	H _b	H _d	H	(in)				
				a	b	c	d	e
B	—	—	—	-	≥ 4	-	-	-
A,B,C,	—	—	—	≥ 12	≥ 4	≥ 4	-	-
B,E	—	—	—	-	≥ 4	-	-	≥ 40
A,B,C,E	—	—	—	≥ 12	≥ 6	≥ 6	-	≥ 40
D	—	—	—	-	-	-	≥ 40	-
D,E	—	—	—	-	-	-	≥ 40	≥ 40
B,D	H _b < H _d	H _d > H	—	-	≥ 4	-	≥ 40	-
	H _b > H _d	H _d < H	—	-	≥ 4	-	≥ 40	-
B,D,E	H _b < H _d	H _b ≤ 1/2H	—	≥ 10	-	≥ 80	≥ 40	
		1/2H < H _b ≤ H	—	≥ 10	-	≥ 80	≥ 40	
	H _b > H	Prohibited						
	H _b > H _d	H _d ≤ 1/2H	—	≥ 4	-	≥ 80	≥ 40	
		1/2H < H _d ≤ H	—	≥ 8	-	≥ 80	≥ 40	
H _d > H	Prohibited							

Specifications are subject to change without notice. Manufacturer reserves the right to discontinue or modify specifications or designs without notice or without incurring obligations. All Rights reserved.



SUBMITTAL DATA: FLEXX60HP230V1BH / FLEXX60AC230V1AO 60000 BTU/H Unitary Cooling Only Split System

Job Name	Location	Date
Purchaser	Engineer	
Submitted To	For	
Unit Designation	Schedule No.	

FLEXX60HP230V1BH	FLEXX60AC230V1AO
-------------------------	-------------------------



GENERAL FEATURES

- High Efficiency DC Inverter Technology**
- Compact and Quiet 55 dB(A) Side Discharge Outdoor Unit**
- Zero Lot Line Design**
- Match with Gree or Competitive Indoor Unit**
- Designed for New Construction or Replacement Market**
- 24VAC Thermostat Compatible**
- Cooling Range 40°F to 118°F**

Acrylic Resin/Anti-Corrosion Fin Coating (Blue - 500 Hr Salt Spray Rating)

5 Year Limited Compressor & Parts Warranty (Residential Only)

SPECIFICATIONS		FLEXX60HP230V1BH / FLEXX60AC230V1AO	
System Type		COOLING ONLY	
SYSTEM PERFORMANCE			
Cooling	Rated Capacity @ 95°F	Btu/h	54000
	Min-Max Capacity	Btu/h	35000 - 54000
SEER / EER		17 / 10.5	
Energy Star®		NO	
Cooling Temperature Range		°F	40 - 118
INDOOR UNIT		FLEXX60HP230V1BH	
Fan Motor Output Power		W	746
Fan Motor FLA		amps	5
Air Flow (Min - Max)		CFM	1600
Static Pressure (Rated / Maximum)		In w.c	0.2 / 1.0
Sound Pressure Level		dB(A)	51
Dehumidification		pt/hr	12.13
Condensate Drain Size (OD)		in	3 / 4
Unit Dimension (WxHxD)		in	24 3/4 x 57 x 21 1/4
Package Dimension (WxHxD)		in	27 5/16 x 59 3/8 x 26
Weight (Net / Gross)		lbs	202 / 218
Electric Heater (Optional)		kW	10, 15, 20
OUTDOOR UNIT		FLEXX60AC230V1AO	
Compressor Type		Inverter Rotary	
Compressor RLA		amps	19
Fan Motor Output Power (2)		W	149 Ea
Fan Motor (2)		amps	1.5 Ea
Sound Pressure Level		dB(A)	58
Unit Dimension (WxHxD)		in	37 1/4 x 56 1/3 x 16 3/16
Package Dimension (WxHxD)		in	40 7/8 x 62 1/4 x 17 1/4
Weight (Net / Gross)		lbs	262.4 / 288.8
Refrigerant Charge - R410A		oz	194
Coil Type (Blue Fin)		Copper Tube / Aluminum Fin	
REFRIGERANT PIPING			
Line Set Size (Liquid - Gas)		in	3/8 - 3/4
Pre-Charge Length		ft	31
Additional Charge		oz/ft	0.32
Pipe Length (Min - Max)		ft	10 - 100
Max. Pipe Elevation		ft	50
ELECTRICAL			
Power Supply (Voltage Operating Range)		208/230V / 1Ph / 60 Hz	
Outdoor Unit	Rated Current	amps	30
	MCA / MOCP	amps	35 / 45
Indoor Unit	Rated Current	amps	5
	MCA / MOCP	amps	8 / 15
Main Power Wire Size		AWG	Size Per Local Code
LIMITED WARRANTY		5 Years Parts and Compressor - Residential	

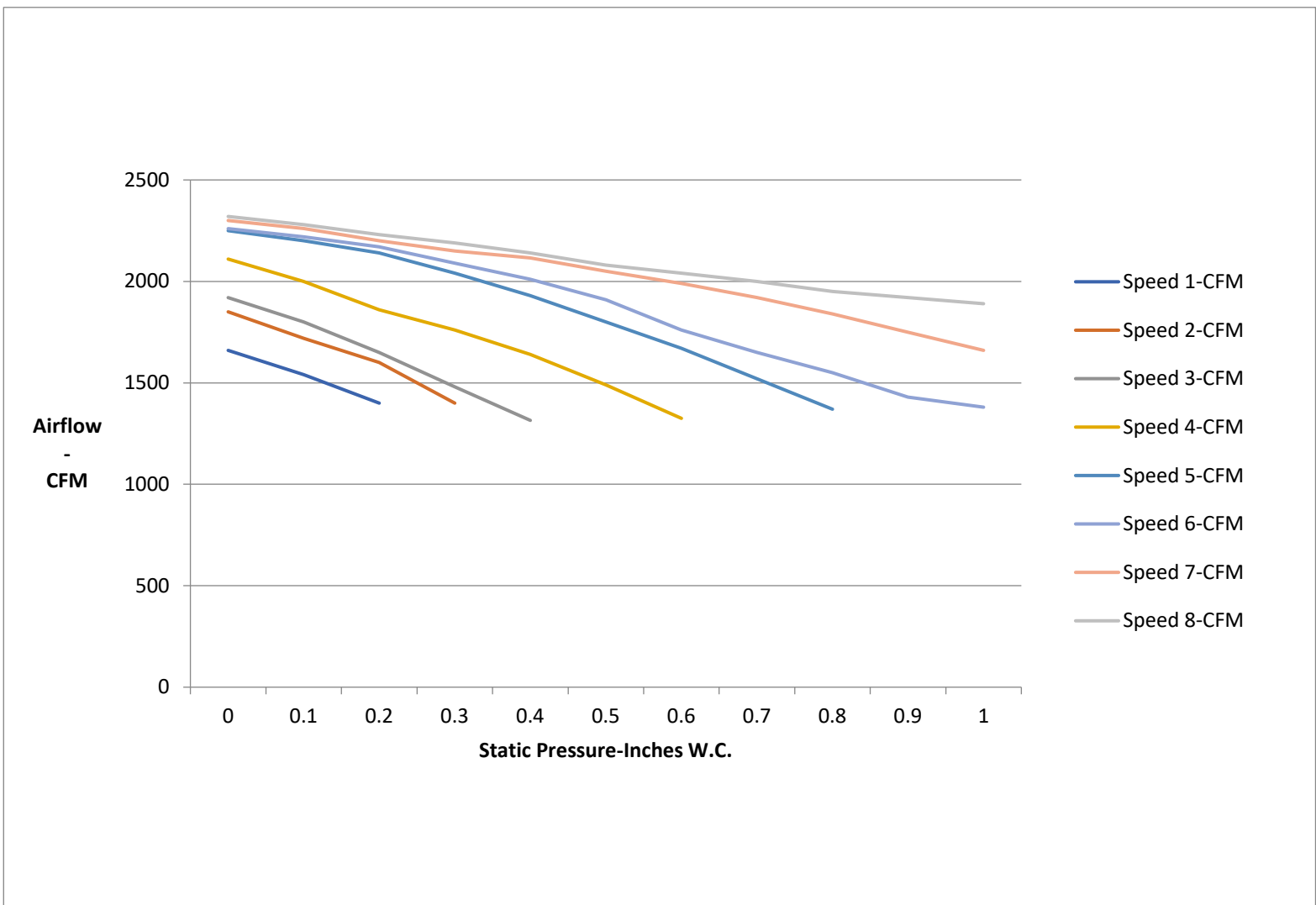

Static Pressure Inches W.C.	0	0.1	0.15	0.2	0.3	0.4	0.5	0.6	0.7	0.8	0.9	1.0
Speed 1-CFM	1660	1540	1470	1400								
Speed 2-CFM	1850	1720	1650	1600	1400							
Speed 3-CFM	1920	1800	1730	1650	1480	1315						
Speed 4-CFM	2110	2000	1950	1860	1760	1640	1490	1325				
Speed 5-CFM	2250	2200	2190	2140	2040	1930	1800	1670	1520	1370		
Speed 6-CFM	2260	2220	2200	2170	2090	2010	1910	1760	1650	1550	1430	1380
Speed 7-CFM	2300	2260	2230	2200	2150	2115	2050	1990	1920	1840	1750	1660
Speed 8-CFM	2320	2280	2250	2230	2190	2140	2080	2040	2000	1950	1920	1890

COOLING PERFORMANCE					
Outdoor Ambient Temperature (DB)		Return Air Temperature			
		80°F (DB)			
		TC (Btu/h)	SHR	EER	Power Input (W)
MAX OUTPUT	40°F	54000	69.5%	13.6	3980
	45°F	54000	71.2%	13.4	4040
	50°F	54000	70.0%	13.2	4080
	55°F	54000	70.8%	13.1	4120
	60°F	54000	71.0%	13.0	4160
	65°F	54000	70.0%	12.8	4210
	70°F	54000	71.5%	12.6	4290
	75°F	54000	69.8%	12.4	4360
	80°F	54000	70.4%	12.1	4460
	85°F	55000	69.5%	11.9	4610
	90°F	55000	71.7%	11.1	4960
	95°F	55000	70.0%	10.2	5370
	100°F	55000	70.8%	9.2	5960
	105°F	54000	69.0%	8.2	6610
	110°F	50000	70.9%	8.1	6140
	115°F	46000	71.0%	8.1	5660
118°F	38000	68.7%	7.7	4960	

LEGEND: W - Watts
 DB - Dry Bulb
 TC - Total Capacity
 SHR - Sensible Heat Ratio

FEATURES SUMMARY**FLEXX60HP230V1BH / FLEXX60AC230V1AO**

SYSTEM FEATURES	
Inverter Type	G10
Ultra Low Frequency Torque Control	Yes
Power Factor Correction	Yes
Compressor Type	Rotary
Basepan With Electric Heater	No
Indoor & Outdoor Fin Coating	Yes
Low Voltage Startup	Yes
Memory/Power Failure Recovery	Yes
Self Diagnosis	Yes
Smart Thermostat / 24V Thermostat Compatible	Yes
Wired Controller Interface	No
WiFi Included	No
Indoor Fan Type	Centrifugal
Multi Fan Speeds	8
Rated External Static Pressure	0.1
External Static Pressure (Min - Max)	0 - 1.0
Indoor Unit Display	No
Auxiliary Electrical Heater	Optional
Ventilation (Outdoor Air)	No

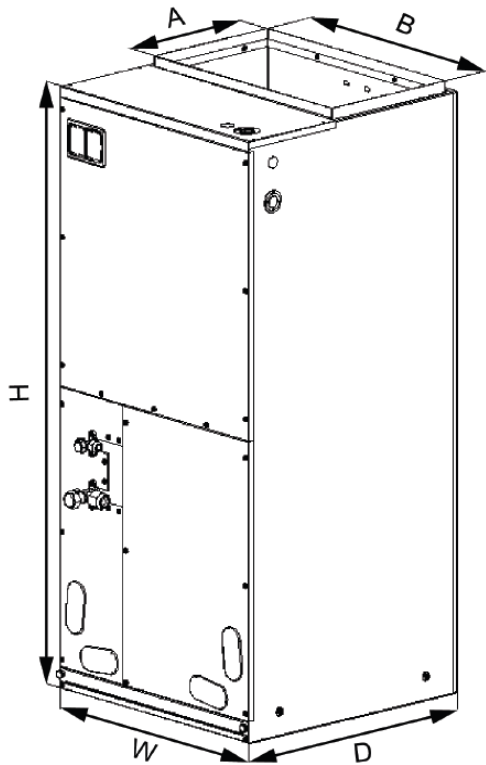

Dimensions	
A	11 5/8
B	20
H	57
W	24 3/4
D	21 1/4

Filter Size	
Supplied*	20 5/8 x 20 5/16 x 1/2
Suggested	20 5/8 x 20 5/16 x 1

*Supplied filter is metal mesh

Clearances	
Front	> 24

Allow a minimum of 24" in front of the unit for service clearance. When installing in an area directly over a finished ceiling (such as an attic), an emergency drain pan is required directly under the unit. **See local and state codes for requirements.** When installing this unit in an area that may become wet, elevate the unit with a sturdy, non-porous material. In installations that may lead to physical damage (i.e. a garage) it is advised to install a protective barrier to prevent such damage. This air handler is designed for a complete supply and return ductwork system.

Multi-Position Capabilities

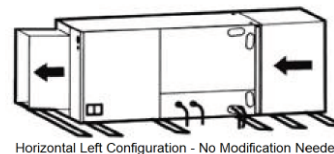
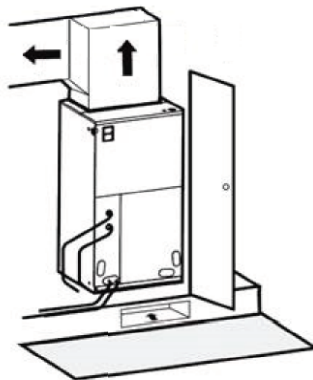

Horizontal Left Configuration - No Modification Needed

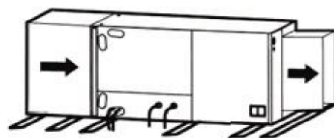

Horizontal Right Configuration - Must Relocate Drain Pan

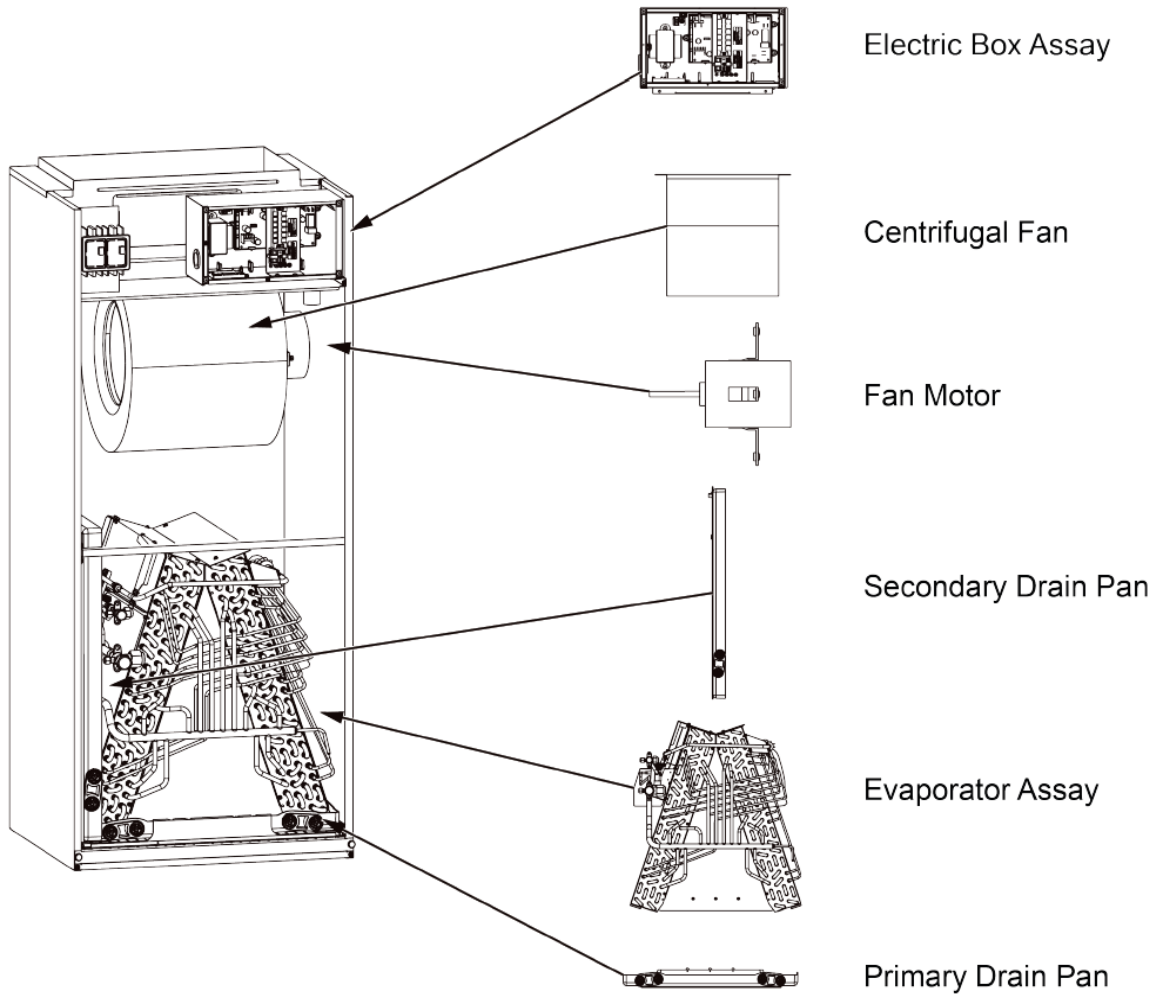

Model	Heat Kit Model	Electric Heat (kW)		Min. Circuit		Max.Fuse or Breaker	
		240V	208V	240V	208V	240V	208V
FLEXX60HP230V1BH	FLEXXHTR10KW	10	7.51	52	45	60	45
	FLEXXHTR15KW	15	11.25	52 & 26	45 & 22.6	60 & 30	45 & 25
	FLEXXHTR20KW	20	15.02	52 & 52	45 & 45	60 & 60	45 & 45
	21-4216-01	10	7.51	52	45	60	45
	21-4217-00	15	11.25	52 & 26	45 & 22.6	60 & 30	45 & 25
	21-4228-00	20	15.02	52 & 52	45 & 45	60 & 60	45 & 45

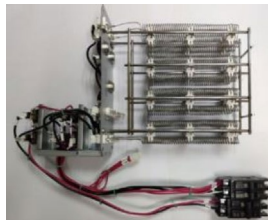

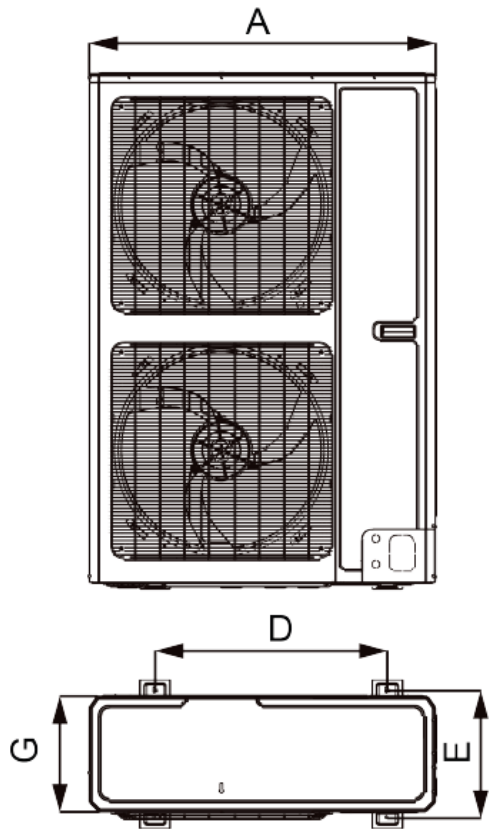

Dimensions	
A	37 1/4
B	16 3/16
C	56 1/3
D	24 7/8
E	13 7/8
G	12 5/8

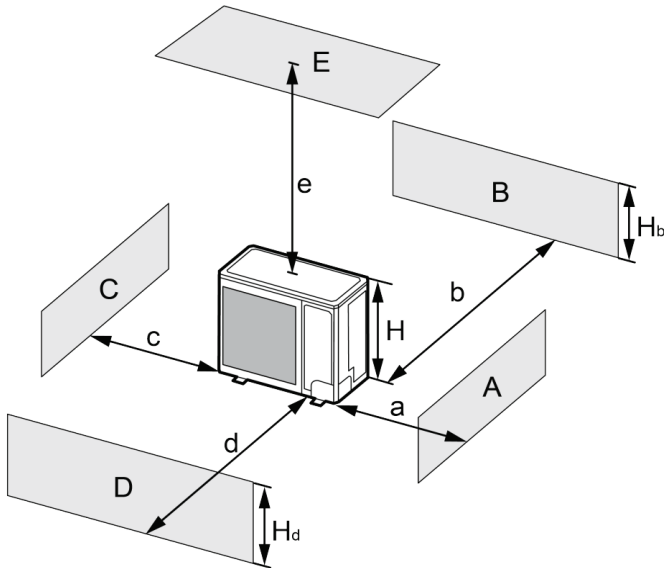

A~E	H _b	H _d	H	(in)				
				a	b	c	d	e
B	—	—	—	-	≥ 4	-	-	-
A,B,C,	—	—	—	≥ 12	≥ 4	≥ 4	-	-
B,E	—	—	—	-	≥ 4	-	-	≥ 40
A,B,C,E	—	—	—	≥ 12	≥ 6	≥ 6	-	≥ 40
D	—	—	—	-	-	-	≥ 40	-
D,E	—	—	—	-	-	-	≥ 40	≥ 40
B,D	H _b < H _d	H _d > H	—	-	≥ 4	-	≥ 40	-
	H _b > H _d	H _d < H	—	-	≥ 4	-	≥ 40	-
B,D,E	H _b < H _d	H _b ≤ 1/2H	—	-	≥ 10	-	≥ 80	≥ 40
		1/2H < H _b ≤ H	—	-	≥ 10	-	≥ 80	≥ 40
	H _b > H		Prohibited					
	H _b > H _d	H _d ≤ 1/2H	—	-	≥ 4	-	≥ 80	≥ 40
		1/2H < H _d ≤ H	—	-	≥ 8	-	≥ 80	≥ 40
H _d > H		Prohibited						

Specifications are subject to change without notice. Manufacturer reserves the right to discontinue or modify specifications or designs without notice or without incurring obligations. All Rights reserved.