

Heat Recovery Ventilator VH30160R

CLEAN COMFORT™
INDOOR AIR ESSENTIALS

Features

- Four operating modes (Intermittent, Continuous, Recirculation and High)
- 100% variable speed
- ISF™ (Insert, Slide and Fix) 6" (153 mm) dia. collar system
- Advanced proportional supply fan shut-down defrost sequence
- Factory-installed, adjustable hanging strap system
- Dual permanently lubricated PSC motors
- Integrated auxiliary furnace interlock relay
- Ventilator can be balanced by adjusting each motor independently; no balancing dampers required
- Connection terminals for optional wall controls
- Quiet operation

Heat Recovery Core

- Transfers sensible heat
- Effective in warm and cold climates
- Water washable

Optional Accessories

- Matrix 2-in-1 high-performance concentric ventilation hood

Certifications and Standards

- HVI Certified
- CSA C439 Standard (Packaged Heat/Energy Recovery Ventilators (HRV/ERV))
- CSA Standard CSA 22.2 NO.113-10 (Fans and ventilators)
- UL Standard 1812 2nd Ed. Ducted Heat/Energy Recovery Ventilators (HRV/ERV)



Airflow (Front View)

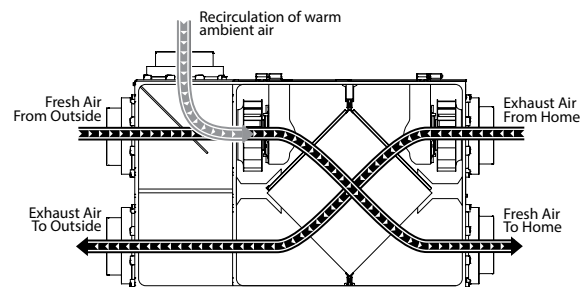

Proprietary Notice

This document and the information disclosed herein are proprietary data of Daikin North America LLC. Neither this document nor the information contained herein shall be reproduced, used, or disclosed to others without the written authorization of Daikin North America LLC except to the extent required for installation or maintenance of recipient's equipment.

Liability Notice

Daikin North America LLC does not accept any liability for installations of ventilation equipment installed by unqualified personnel or the use of parts/components/equipment that are not authorized or approved by Daikin.

Copyright Notice

Copyright 2015, Daikin North America LLC All rights reserved.

Specifications VH30160R

Cabinet

Dimensions 37½" x 22½" x 16½"
(952.5 mm x 571.5 mm x 419.1 mm)

Construction 20-gauge galvanized pre-painted steel corrosion-resistant liner: molded expanded Polystyrene (EPS) Rated UL94 HF-1

Duct Connections Five, 6" (152.5 mm) dia. ISF double collar system

Airflow Rates 30 CFM (14 L/s) to 160 CFM (76 L/s)

Motors Two PSC variable-speed backward curved
Maximum RPM 2695; 3/32 HP, class F, thermally protected

Voltage 120 VAC @ 60 Hz / 1 Phase

Amperage 1.5 A / 142 W

Electronic Components Circuit output voltage: 5VDC nominal compliant
RoHS compliant

Heat Exchanger Exchange surface Polypropylene HRV Core
85 ft² (7.9 m²)
Dimensions 12" L x 12" W x 10" D
(304.8 mm x 304.8 mm x 254 mm)
Construction Corrugated cross-flow polypropylene layers
Recognized UL94 HB and HF-1

Defrost type Recirculation

Filters Two Fiberbond washable
11-11/16" x 9-3/4" x 5/8"
(297 mm x 248 mm x 16 mm)

Drain Connection ½" (12.7 mm)

Actual Weight 59 lbs (26.8 Kg)

Shipping Weight 65 lbs (29.5 Kg)

Optional Wall Controls

Mechanical VHP-RD3D

Timers VHP-T3 (20, 40, 60 minutes)

Wall Control Dimensions

VHP-RD3D

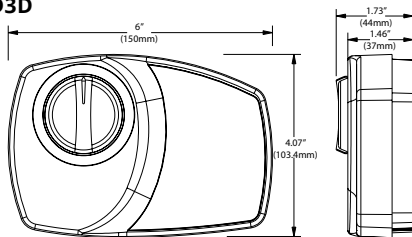

VHP-T3 Timer

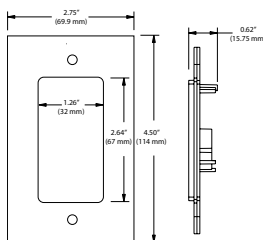

Dimensional Data

Front View

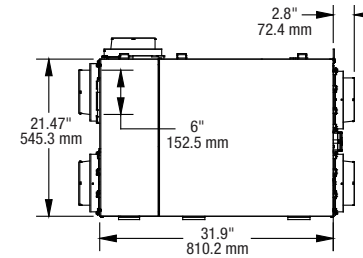

Top View

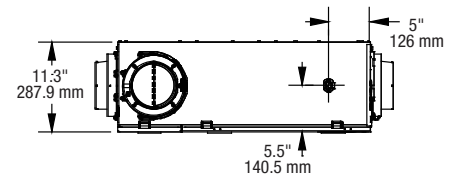

Minimum Clearance Data

Front View

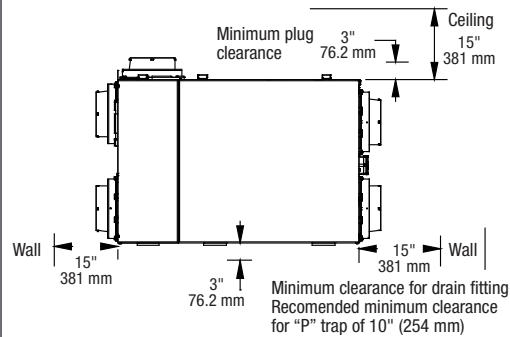

Top View

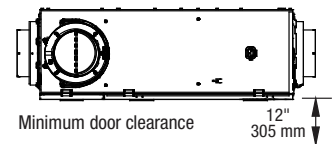

Ventilation Performance

External Static Pressure	Net Supply Airflow		Gross Airflow Supply		Gross Airflow Exhaust		
	Pa	In. wg	L/s	CFM	L/s	CFM	L/s
25	0.1	89	189	90	191	113	239
50	0.2	81	173	82	174	104	221
75	0.3	75	159	75	160	94	200
100	0.4	69	146	69	148	84	179
125	0.5	62	132	63	133	77	163
150	0.6	57	121	58	122	66	140
175	0.7	53	112	53	113	57	121

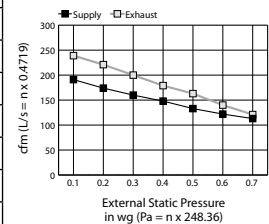

Energy Performance

	Supply Temperature		Net Airflow		Power Consumed (Watts)	Sensible Recovery Efficiency
	°C	°F	L/s	CFM		
Heating	0	32	32	68	90	68
	0	32	43	92	104	67
	0	32	56	119	114	65
	-25	-13	32	67	92	64

Our continuing commitment to quality products may mean a change in specifications without notice.

© 2015 • DAIKIN NORTH AMERICA LLC • Houston, Texas • Printed in the USA.